

**TRPA  
GOVERNING BOARD  
PACKETS**

**APRIL  
1986**

APRIL 86 GB

TAHOE REGIONAL PLANNING AGENCY  
NOTICE OF MEETINGS

NOTICE IS HEREBY GIVEN that on Wednesday, Thursday, and Friday, April 23, 24 and 25, 1986, commencing at 10:00 a.m. on the 23rd and at 9:30 a.m. on the 24th and 25th, at the TRPA office, 195 U.S. Highway 50, Round Hill, Zephyr Cove, Nevada, the Governing Body of the Tahoe Regional Planning Agency will conduct its regular meeting. The agenda for said meeting is attached to and made a part of this notice.

NOTICE IS FURTHER GIVEN that at 8:30 a.m. on Wednesday, April 23, in the TRPA office, the Rules and Regulations Committee will meet to discuss the following: 1) revision of the Agency's Rules and Regulations of Practice and Procedure and the Administrative and Fiscal Procedures Manual; and 2) a resolution adopting rules for a Plan for 1986.

NOTICE IS FURTHER GIVEN that on Wednesday, April 23, 1986, commencing at 9:30 a.m. in the same location, the Litigation Committee will meet in open session and in closed session to confer with counsel on the following: 1) State of California/ League to Save Lake Tahoe v. TRPA; 2) Tahoe Sierra Preservation Council v. TRPA, et al. (Eastern District of California and District of Nevada); 3) Lakeview Development v. TRPA; and 4) authorization for legal counsel to obtain exemption from injunction for vested rights determinations.

NOTICE IS FURTHER GIVEN that at the conclusion of the Wednesday, April 23, 1986 regular meeting session, the Legislation Committee will meet to discuss legislation affecting the Tahoe Basin.

NOTICE IS FURTHER GIVEN that on Thursday, April 24, 1986, commencing at 8:30 a.m. in the same location, the Finance Committee of said agency will meet to discuss the following: 1) receipt of the March financial statement; 2) recommendation on withdrawal from Nevada PERS and a new retirement system; 3) status of the Agency's liability insurance and safety management program; 4) reimbursement of \$39,535 in interest to the CTRPA security fund; 5) receipt of the FY 1984-85 Audit Report; 6) receipt of STA Fund audit; 7) allocation of FY 83-84 LTF to the City of South Lake Tahoe; 8) budget revisions; and 9) reimbursement to Ralph Andersen and Associates of expenses incurred by Executive Director applicants.

Date: April 7, 1986

By: W.A. Morgan

William A. Morgan  
Executive Director  
Tahoe Regional Planning Agency

NOTE Items on the agenda without a time designation may not necessarily be considered in the order in which they appear on the agenda.

TAHOE REGIONAL PLANNING AGENCY  
GOVERNING BODY

TRPA Office, 195 U.S. Highway 50  
Round Hill, Zephyr Cove, Nevada

NOTE: April 23, 1986 10:00 a.m.  
April 24, 1986 9:30 a.m.  
April 25, 1986 9:30 a.m.

---

PRELIMINARY AGENDA

I CALL TO ORDER AND DETERMINATION OF QUORUM

II APPROVAL OF AGENDA

III DISPOSITION OF MINUTES

IV SPECIAL WORKSHOP - Wednesday, April 23 - 10:15 a.m.

Joint Workshop Between TRPA Governing Board Members  
and Participants in the Consensus-Building Process

V SPECIAL PLANNING MATTER

A. Consideration of Revisions to the Regional Plan Goals and Policies

1. Public Testimony

VI LITIGATION

A. Approval of Revisions to Plan for 1986 Exemption from Injunction

B. Approval of a Resolution Adopting Rules and Regulations for a Plan for 1986

1. Public Testimony

C. Authorization for Legal Counsel to Obtain Exemption from Injunction for Vested Rights Determinations

D. Litigation Committee Report and Board Action, If Necessary, on the Following:

1. State of California/League to Save Lake Tahoe v. TRPA

2. Tahoe Sierra Preservation Council v. TRPA, et al. (Eastern District of California and District of Nevada)

3. Lakeview Development v. TRPA

E. Closed Session to Confer on the Following:

1. State of California/League to Save Lake Tahoe v. TRPA

2. Tahoe Sierra Preservation Council v. TRPA, et al. (Eastern District of California and District of Nevada)

3. Lakeview Development v. TRPA

---

Thursday, April 24 - 9:30 a.m.

VII CONSENT CALENDAR

VIII SPECIAL REPORT

Tahoe-Transportation District (TTD) Status Report

IX PLANNING MATTERS

- (A.) Approval of the TTD Short Range Transit Program
- (B.) Status Report on Supplement to EIS for Adoption of a Regional Plan for the Lake Tahoe Basin and Report on Comment Period
- (C.) Clearinghouse Review and Approval of Recommendation on Tahoe Tomorrow Foundation UMTA Grant Application

X ADMINISTRATIVE MATTERS

- A. Finance Committee Report and Board Action on Recommendations
  - 1. Receipt of the March Financial Statement
  - 2. Withdrawal from the Nevada Public Employees Retirement System and Establishment of New Retirement System
  - 3. Reimbursement of \$39,535 in Interest to CTRPA Security Fund
  - 4. Receipt of FY 1984-85 Audit Report
  - 5. Approval of Budget Revisions
  - 6. Approval of Reimbursement to Ralph Andersen and Associates for Executive Director Applicant Expenses
  - (7.) Receipt of State Transit Assistance (STA) Fund Audit Report
  - (8.) Adoption of Resolution for Allocation of Balance of 1983-84 Local Transportation Funds to the City of South Lake Tahoe
- B. Legislation Committee Report
  - 1. Status Report Regarding AK & Associates Monitoring of the Budget Process in the California Legislature
- (C.) Approval of MOU Between TRPA and Caltrans Establishing Intergovernmental Review Process for Federal Aid Transportation Funds

XI RESOLUTIONS

- A. Resolution Amending Section 23 (Retirement Program) of the Administrative and Fiscal Procedures Manual
1. Public Testimony
  2. Adoption of Resolution

XII REPORTS

- A. Executive Director
1. Status Report on Projects Approved at Staff Level
  2. Status Report on Exemption Requests in Regional Plan Suit
  3. Status Report on Tahoe Queen EIS Comment Period (April 4 Through June 3, 1986)
- B. Legal Counsel
- C. Governing Body Members
- D. Public Interest Comments

XIII CORRESPONDENCE

XIV ADJOURNMENT

---

CONSENT CALENDAR

<u>Item</u>	<u>Recommended Action</u>
Continental Telephone, Conduit Extension Marla Bay Improvement District, Douglas County APN 560-100-00	Approval With Findings And Conditions
CP National Gas Main Extensions in El Dorado County	Approval With Findings And Conditions
- Tahoe Paradise, APN 520-300-00 TRPA File #85751	
- 1000 Highway 50, Meyers, APN 520-300-00	
- Saddle Road, APN 510-300-00	
- Woodbine Road and Rockwood, APN 520-300-00	
Douglas County Parks, Kingsbury Paved Bike Path, Pine Ridge Drive to Kingsbury Middle School	Approval With Findings And Conditions
City of South Lake Tahoe, Request for Mitigation Funds to Aid in Beach Bus Program	Release Funds

# TAHOE REGIONAL PLANNING AGENCY

P.O. Box 1038  
Zephyr Cove, Nevada 89448-1038

195 U.S. Highway 50  
Round Hill, Zephyr Cove, NV

(702) 588-4547

## MEMORANDUM

April 15, 1986

To: TRPA Governing Board

From: Susan E. Scholley, Legal Counsel

Subject: Approval of Revisions to Plan for 1986 Exemption from Injunction

On April 14, 1986, TRPA lodged the Tenth Stipulation Amending Order Granting Preliminary Injunction with the U.S. District Court in Sacramento. A copy is attached.

The stipulation was signed by all the parties to the Regional Plan lawsuit and requires only the approval of the Court to become effective.

The following changes were incorporated into the final version of the Plan for 1986 based upon previous Governing Board discussions.

1. Deleted provision allowing pre-December 19, 1980 permits to rely on Section 9.24 of the TRPA Land Use Ordinance. This provision was deleted after a review of the Washoe and Douglas County files revealed that none of the "eligible to build" county permits had been approved in reliance on Section 9.24. All such county permits were in compliance with the Bailey coefficients. (See I.D.1.)
2. The deadline for submittal of a complete application and transfer of an allocation was changed from one year to December 31, 1986, based upon the recommendation from the TRPA Rules & Regulations Committee. (See I.D.10. & I.E.2.)

SES:mlm  
4/15/86

AGENDA ITEM VI A.

1 GARY A. OWEN, ESQ.  
HEATON, DOESCHER & OWEN, LTD.  
2 P.O.Box 605  
Carson City, NV. 89702  
3 Telephone: (702) 882-2164

4 SUSAN E. SCHOLLEY  
TAHOE REGIONAL PLANNING AGENCY  
5 P.O.Box 1038  
Zephyr Cove, NV. 89448  
6 Telephone: (702) 588-4547

7 Attorneys for Defendant,  
Tahoe Regional Planning Agency

8 **LODGED**

9 IN THE UNITED STATES DISTRICT COURT FOR THE  
APR 14 1986  
10 EASTERN DISTRICT OF CALIFORNIA

11 CLERK, U. S. DISTRICT COURT  
EASTERN DISTRICT OF CALIFORNIA

12 THE PEOPLE OF THE STATE OF CALIFORNIA EX REL. JOHN K. VAN DE KAMP, ATTORNEY GENERAL OF THE STATE OF CALIFORNIA, ) No. CIVS-84-0561 EJG

15 Plaintiff, )

16 vs. )

17 THE TAHOE REGIONAL PLANNING AGENCY, a Separate Legal Entity Created by Bi-State Compact, )  
18 Defendant. ) No. CIVS-84-0565 EJG

21 LEAGUE TO SAVE LAKE TAHOE, a Non-Profit California Organization, ) TENTH STIPULATION AMENDING  
22 ORDER GRANTING PRELIMINARY )  
INJUNCTION AND ORDER THEREON

23 Plaintiff )

24 vs. )

25 THE TAHOE REGIONAL PLANNING AGENCY, a Separate Legal Entity, )  
26 and DOES 1 through 100, )  
27 Defendants. )

28 ///

1 TAHOE-TRUCKEE SANITATION AGENCY, )  
a public agency; TAHOE SHOREZONE )  
2 REPRESENTATION, a Nevada )  
corporation, STATE OF NEVADA, )  
3 )  
Intervenors. )  
4 )

5 IT IS HEREBY STIPULATED, by and between the parties hereto, that  
6 the August 9, 1984 Order Granting Preliminary Injunction may be amended to  
7 allow implementation of the Plan for 1986. The Plan for 1986 is attached  
8 hereto as Exhibit "A" and incorporated herein by reference.

9 IT IS FURTHER STIPULATED, by and between the parties hereto, that  
10 the August 9, 1984 Order Granting Preliminary Injunction may be amended to  
11 exempt settlement of the litigation entitled Spear, et al. v. TRPA, Case  
12 No. CV-R-85-549-BRT, U.S. District Court, District of Nevada, provided the  
13 allocation for the single family residence at issue is counted against the  
14 allocations provided for in the Plan for 1986.

15  
16 TAHOE REGIONAL PLANNING AGENCY

17  
18 DATED: April 11, 1986

Susan E. Scholley  
Susan E. Scholley, Attorney for  
Defendant, TAHOE REGIONAL PLANNING  
AGENCY

21 JOHN K. VAN DE KAMP, ATTORNEY  
GENERAL OF THE STATE OF CALIFORNIA

22  
23 DATED: 11 April, 1986

Richard M. Skinner  
Richard M. Skinner, Attorneys for  
Plaintiff, PEOPLE OF THE STATE OF  
CALIFORNIA EX REL. JOHN VAN DE KAMP  
ATTORNEY GENERAL OF THE STATE OF  
CALIFORNIA

27 ///  
28 ///



1  
2  
3  
4  
5  
6  
7  
8  
9  
10  
11  
12  
13  
14  
15  
16  
17  
18  
19  
20  
21  
22  
23  
24  
25  
26  
27  
28

SHUTE, MIHALY & WEINBERGER

DATED: April 11, 1986

E. Clement Shute  
E. Clement Shute, Attorneys for  
Plaintiff, LEAGUE TO SAVE LAKE TAHOE

TAHOE-TRUCKEE SANITATION AGENCY

DATED: \_\_\_\_\_, 1986

John C. Weidman  
John C. Weidman, Attorney for  
Intervenor, TAHOE-TRUCKEE SANITATION  
AGENCY

TAHOE SHOREZONE REPRESENTATION

DATED: April 14, 1986

William T. Chidlaw  
William T. Chidlaw, Attorney for  
Intervenor, TAHOE SHOREZONE  
REPRESENTATION

BRIAN MC KAY, ATTORNEY GENERAL  
OF THE STATE OF NEVADA

DATED: April 14, 1986

Marta Adams  
MARTA ADAMS, Attorneys for  
Intervenors, STATE OF NEVADA

IT IS SO ORDERED.

DATED AND DONE this \_\_\_\_\_ day of \_\_\_\_\_, 1986.

\_\_\_\_\_  
UNITED STATES DISTRICT JUDGE

TRPA'S PLAN FOR 1986

I. RESIDENTIAL DEVELOPMENT

A. Allocations

1. TRPA shall determine allocation limits and which classes of projects are eligible for allocations.
2. Distribution within those allocation limits shall be determined by the counties and city. If any county or city shall choose not to distribute allocations, then TRPA shall distribute them.
3. The allocation limits are set forth on the attached chart.
4. Unused or forfeited allocations shall be returned to the counties and city and may be carried over into the next year's allocation.

B. The following classes of projects and parcels are eligible for allocations to build within the limits set in A. above:

1. Placer County permits which are due to expire on August 1, 1986, which have expired CTRPA/TRPA permits, have not yet commenced construction, and are on parcels in land capability districts 4 - 7.
2. Local county building permits which were issued prior to December 19, 1980, have been continuously renewed, have not started construction, are on parcels in land capability districts 4 - 7, and are either in compliance with the Bailey coefficients or have been brought into conformance with the Bailey coefficients.
3. Single family dwelling projects in land capability districts 4 - 7 which were approved by TRPA prior to August 27, 1983 and which did not receive a permit prior to May 1, 1984.
4. Parcels in land capability districts 4 - 7 which received a 1983 allocation from Placer County, El Dorado County, and the City of South Lake Tahoe, have the requisite infrastructure, and are within the urban boundaries.
5. Parcels located in land capability districts 4 - 7 that have the requisite infrastructure and are within the urban boundaries.

C. Allocations for purposes of transfer are subject to the limits set in A. above. The following classes of parcels and projects are eligible for an allocation to transfer but are not eligible to build:

1. Nevada case-by-case approvals for single family dwelling which were approved by TRPA prior to August 27, 1983 but which did not receive a permit prior to May 1, 1984.
2. Parcels which received a 1983 California allocation and are located in land capability districts 1 - 3.

3. Parcels located in land capability districts 4 - 7 which are either outside urban boundaries or do not have the requisite infrastructure, and which received a 1983 California allocation.
4. Placer County permits which are due to expire on August 1, 1986, which have expired CTRPA/TRPA permits, have not yet commenced construction, and are on parcels in land capability districts 1 - 3.
5. Local county building permits which were issued prior to December 19, 1980, have been continuously renewed, have not started construction, and are on parcels in land capability districts 1 - 3.
6. Local county building permits which were issued prior to December 19, 1980, have been continuously renewed, have not started construction, are on parcels in land capability districts 4 - 7, and are not in, or cannot be brought into, compliance with the Bailey coefficients.
7. Parcels located in land capability districts 4 - 7 which are either outside urban boundaries or do not have the requisite infrastructure.

D. Rules for residential construction shall be as follows:

1. Bailey land coverage coefficients shall be applied on a parcel basis except that subdivisions, or portions thereof, which are consistent with the Bailey coefficients overall and were approved by TRPA without reliance on Sections 7.83, 8.25(2), 8.25(3), 8.28, 8.34 or 9.23 of the TRPA Land Use Ordinance, may be permitted the coverage shown on the subdivision map for parcels located in land capability districts 4 - 7.
2. To be eligible to build, parcels with a Placer County permit (B.1.), and parcels with 1983 California allocations (B.4.) must be found to be served by at least three of the following infrastructure requirements:
  - (a) paved roads; (b) sewer; (c) electricity; or (d) water.
3. Pre-December 19, 1980 local permits (B.2.) and prior TRPA approvals (B.3.) shall be subject to whatever infrastructure requirements were applicable at the time of the original approval except as otherwise set forth herein.
4. Other parcels (B.5) must be served by the following infrastructure requirements:
  - (a) paved roads; (b) sewer; (c) electricity; and (d) water.

5. If eligible for an allocation to build, parcels with a Placer County permit (B.1.), and pre-December 19, 1980 local permits (B.2.), may be reissued approvals, which approvals shall be valid for three years pursuant to Article VI(p) of the Compact.
6. All approvals (reissued or new) shall begin construction within the three year approval period and shall complete construction, as defined by TRPA, within two years once construction is commenced.
7. All approvals and construction shall be subject to installation of BMPs on the parcel.
8. All approvals and construction shall be subject to review under the amended regional plan standards for woodstoves, heaters, and related provisions.
9. The residential height rules shall be those rules in effect on August 25, 1983.
10. Parcels which are eligible to build and require TRPA review, shall submit a complete application no later than December 31, 1986. Failure to do so will result in the forfeiture of the allocation.

E. Rules for transfer of residential development allocations (TDR) shall be as follows:

1. Transfer of allocations shall only be to parcels located in land capabilities 4 - 7 inside the urban boundaries and which have the requisite infrastructure, and shall also result in the permanent dedication of the transferor parcel to open space. Allocations may be transferred between parcels in common ownership prior to acquisition of the allocation without a requirement to dedicate or donate the transferor parcel provided the transferor lot is located in land capability districts 4 - 7, has the requisite infrastructure, and is within the urban boundaries.
2. Failure to complete the transfer of an allocation by December 31, 1986 shall result in forfeiture of the allocation.
3. Multi-family residential projects with a pre-December 19, 1980 local permit (C.5. & C.6.), shall be allowed one TDR for each residential unit (i.e. triplex receives three TDR's).
4. The Nevada case-by-case approvals (C.1.) shall be allowed one TDR which shall not be counted in the allocations for the Plan for 1986. However, any transferred allocations shall be accounted for against subsequent years' allocations.

## II. COMMERCIAL DEVELOPMENT

A. The following projects have been identified as pre-August 26, 1983 approvals which did not receive permits prior to May 1, 1984:

1. Blankenship Office Bldg. TRPA File No. 82156. (10,698 sq. ft.)
2. Moran Professional Office Building. TRPA File No. 82108. (2,102 sq. ft.)
3. Strong Office Building. TRPA File No. 81-1152. (3,892 sq. ft.)

B. The above projects may receive a permit upon satisfaction of the conditions of the approvals. Implementation of this agreement will cease the tolling of the approvals.

C. Addition of new commercial square footage to existing structures shall be permitted only: where ordered by a state, county or city department pursuant to a health or safety code; where such addition is found to be the only feasible way to meet health or safety codes; and then only to the minimum extent necessary to meet the code requirements.

## III. PUBLIC SERVICE, RECREATION and OTHER FACILITIES

A. Applications for, and approval of, public service, recreation and other facilities or development, shall be provided for through specific exemptions from the preliminary injunction.

## IV. CAPITAL IMPROVEMENT PROGRAM

A. The following capital improvements are expected to be either funded or constructed in the 1986 building season:

1. Water Quality and Erosion Control

<u>Project Name</u>	<u>Expected Oct. 1986 Status</u>	<u>Responsible Agency</u>	<u>Total Project Cost</u>
N. of Airport to Wye	Constructed	Caltrans	\$620,000
Elizabeth Dr.	Constructed 86/87	Caltrans	300,000
Bliss #3	Constructed	Caltrans	798,000
Rubicon Palisades	Constructed	El Dorado	869,000
Rubicon - Other	Designed	El Dorado	1,821,000
Upper Truckee I	Constructed	El Dorado	57,000
Upper Truckee II	Designed	El Dorado	200,000
Service Area No. 5	Designed	El Dorado	3,933,000
Bijou/Wildwood I	Constructed	City SLT	3,100,000
Bijou/Wildwood II	Designed	City SLT	4,800,000

<u>Project Name</u>	<u>Expected Oct. 1986 Status</u>	<u>Responsible Agency</u>	<u>Total Project Cost</u>
Regan Beach I	Constructed	City SLT	650,000
Saddle Road	Designed	City SLT	175,000
West Sierra Tract	Designed	City SLT	180,000
"D" Street	Constructed	City SLT	970,000
Airport Erosion	Designed	City SLT	600,000
County Yard	Designed	Douglas Co.	182,000
Zephyr Heights	Constructed	Douglas Co.	75,000
Fairview - Incline	Constructed	Washoe Co.	600,000
Crystal Bay - Incline	Designed	Washoe Co.	591,000
Skyland	Constructed	Placer Co.	177,000
Dollar Point	Constructed	Placer Co.	730,000
McKinney Estates	Constructed	Placer Co.	570,000
Alpine Peaks	Designed	Placer Co.	360,000
Carnelian Woods	Constructed	Placer Co.	300,000
Talmon Estates	Constructed	Placer Co.	289,000
Estates Drive II	Constructed	Placer Co.	587,000
Trout Street	Designed	Placer Co.	50,000
Carnelian Drive	Designed	Placer Co.	475,000
Various Water Tanks	Designed/Constructed	STPUD	100,000
Various Water Tanks	Designed/Constructed	NTPUD	50,000
Spooner Maint. Yard	Constructed	NDOT	300,000

## 2. Transportation & Air Quality

<u>Project Name</u>	<u>Oct. 1986 Status</u>	<u>Responsible Agency</u>	<u>Total Project Cost</u>
Pioneer Trail to Park Avenue, Signal and Intersection Improvements	Constructed	Caltrans	\$190,000
Beach Bus	Service Extension	City SLT	30,000
TART Maintenance Facility	Designed	TART	300,000
U.S. 50 Demonstration Bus Project	Planning Study	TRPA, TTD, TTF	50,000
3rd Street	Constructed	City SLT	350,000
Tahoe City WYE	Designed	Caltrans	200,000
Mail Sub-station	Constructed	Postal Service	250,000

### 3. SEZ Restoration

<u>Project Name</u>	<u>Oct. 1986 Status</u>	<u>Responsible Agency</u>	<u>Total Project Cost</u>
Perini Property	Designed	TCPUD	\$ 75,000
Snow Creek	Constructed	Placer Co.	570,000
Griff Creek #2	Constructed	Placer Co.	350,000
Keller Road	Constructed	USFS	70,000
Lake Country	Constructed	Cal State Parks	219,000

### V. MONITORING PROGRAM

A. The following monitoring programs are expected to be designed, funded, commenced or continued during the 1986 building season:

#### 1. Water Quality

- a. Pelagic Zone - The Tahoe Research Group (TRG) will continue to monitor trends in Lake Tahoe's clarity and primary productivity through June 30, 1986. Lahontan Regional Water Quality Control Board staff assists with this program.
- b. Tributary Streams - The USGS and TRG will continue to monitor pollutant loads and stream flows in five major tributary streams, consistent with past monitoring efforts, through June 30, 1986. The USFS will continue to monitor water quality at several other stations in the Tahoe Basin.
- c. Surface Runoff - The TRPA staff will make assessments of BMP applications in the field and will determine the degree of compliance with TRPA conditions of approval. All erosion control projects will have specific monitoring provisions.

#### 2. Air Quality

- a. Carbon Monoxide - The CARB and NDEP will continue to provide continuous monitoring at their four permanent stations on the South Shore. TRPA staff will analyze the results of this monitoring in the annual Reasonable Further Progress (RFP) report. The TRPA, with assistance from Caltrans, NDOT, and the City of South Lake Tahoe, will also monitor traffic volumes on the U.S. 50 corridor, and include these results in the RFP report.

- b. Regional and Subregional Visibility - TRPA staff, with assistance from the Desert Research Institute, will develop specifications for a monitoring program addressing regional and subregional visibility (i.e., visual range). The specifications will include technical, financial, and institutional arrangements for the operation of two integrating nephelometers and a multi-wavelength teleradiometer. (See also Nitrogen Deposition, below.)
  
- c. Nitrogen Deposition - TRPA staff, using the traffic count data obtained from Caltrans, NDOT, and the City, will compute regional vehicle-miles-of-travel (VMT) for the average peak summer day, using the Agency's in-house transportation model. In addition, the staff will develop specifications covering technical, financial, and institutional arrangements for the operation of high-volume samplers to determine ambient levels of particulate nitrate and nitric acid gas. Also, the TRG will continue to monitor nitrogen deposition on the surface of Lake Tahoe with buoys placed at several locations.

3. Scenic Quality--Roadway and Shoreline Units

The TRPA shall prepare, through a contractor, objective standards, criteria, and procedures for carrying out the scenic quality standards of the thresholds and the Regional Plan. This information will include site-specific measures to bring nonconforming roadway and shoreline units into compliance with the scenic thresholds, and to preserve the scenic resources in all units.



RESIDENTIAL ALLOCATION TABLE FOR A PLAN FOR 1986

South Lake Tahoe		
Prior approvals	3	
1983 allocations.....		
	96	
1983 allocations.....	8	TTSA
El Dorado County		
Placer County		
Prior approvals	6	
1983 allocations.....	97	
New/reissued allocations ...		
Douglas County		
Prior approvals	6	
New/reissued allocations	17	
Washoe County		
Prior approvals	32	
New/reissued allocations	35	
Total	300	

CERTIFICATE OF SERVICE BY MAIL

1  
2  
3  
4  
5  
6  
7  
8  
9  
10  
11  
12  
13  
14  
15  
16  
17  
18  
19  
20  
21  
22  
23  
24  
25  
26  
27  
28

Pursuant to FRCP 5(b) I certify that I am an employee of TAHOE REGIONAL PLANNING AGENCY, and that on the 14th day of April, 1986 I deposited for mailing at Zephyr Cove, Nevada, postage prepaid, a true and correct copy of the attached addressed to

E. Clement Shute, Esq.  
Shute, Mihaly & Weinberger  
396 Hayes Street, Suite 1  
San Francisco, CA 94102

Richard M. Skinner  
Deputy Attorney General  
1515 K Street, Suite 511  
Sacramento, CA 95814

William T. Chidlaw, Esq.  
Bartko, Welsh & Tarrant  
One Maritime Plaza, Suite 1440  
San Francisco, CA 94111

John C. Weidman, Esq.  
325 Main Street  
Placerville, CA 95667

Marta Adams  
Deputy Attorney General  
201 South Fall Street, Room 221  
Carson City, NV 89710

  
MARJORIE L. MC CAULEY

RESOLUTION ADOPTING RULES AND REGULATIONS  
IMPLEMENTING THE PLAN FOR 1986

TAHOE REGIONAL PLANNING AGENCY  
RESOLUTION NO. 86 -     

WHEREAS, the Tahoe Regional Planning Agency, as defendant in the action entitled State of California/ League to Save Lake Tahoe v. TRPA, Case Nos. CIVS-84-0561, 84-0565-EJG, has entered into a stipulation exempting certain projects and activities ("The Plan for 1986") from the scope of the preliminary injunction; and

WHEREAS, in furtherance of the Court's approval of said stipulation for the Plan for 1986, the Governing Board of TRPA finds it necessary and desirable to adopt rules and regulations to further implement the Plan for 1986;

NOW THEREFORE BE IT RESOLVED that the attached rules and regulations, and exhibit thereto, shall govern and implement the Plan for 1986 and that where said rules and regulations are inconsistent with the Rules and Regulations of Practice and Procedure of the TRPA, said rules and regulations shall control.

BE IT FURTHER RESOLVED that the rules and regulations adopted hereby shall be effective immediately and shall be effective for the duration of the Plan for 1986.

PASSED AND ADOPTED by the Governing Body of the Tahoe Regional Planning Agency at its regular meeting held on the      day of April, nineteen hundred and eighty six, by the following vote:

Ayes:

Nays:

Abstain:

Absent:

\_\_\_\_\_  
Chairman Stanley G. Hansen  
Tahoe Regional Planning Agency

SES:mlm  
4/15/86

AGENDA ITEM VI B.

RULES & REGULATIONS  
FOR A PLAN FOR 1986

1. These rules shall apply to residential construction during the Plan for 1986 and, to the extent they are inconsistent with TRPA's Rules & Regulations of Practice and Procedure, shall control. Otherwise, the TRPA Rules & Regulations shall continue in full force and effect. These rules are necessary to implement the Tenth Stipulation Amending the Order Granting Preliminary Injunction filed April 15, 1986.
2. TRPA shall distribute the appropriate number of allocations to the counties and city as soon as the Tenth Stipulation is approved and filed by the Court. Distribution of allocations shall be accomplished by providing each county and city with the number of allocation forms which corresponds to the allocation limits set forth in the Plan for 1986. Upon determining the recipients of the Plan for 1986 allocations, the counties and city shall indicate the assessor's parcel number of the allocation recipient on the form and provide TRPA with a list of APN's receiving same. These forms shall then be delivered to the recipient and shall, in addition to the list, constitute evidence of receipt of a Plan for 1986 allocation.
3. If any county or city shall choose not to determine the recipients of the Plan for 1986 allocations in their jurisdiction, then TRPA shall determine the recipients of the Plan for 1986 allocations in that jurisdiction, indicate the assessor's parcel number of the allocation recipient on the allocation form and keep a list of said recipients, and deliver a copy of any such list to the affected jurisdiction.
4. All construction of new single family residences shall be reviewed and approved by TRPA.
  - a. Applications shall not be accepted unless they are complete. No applications shall be accepted after 5:00 P.M., December 31, 1986. Applications for new single family residences shall be complete before Agency review commences.
  - b. A complete application shall consist of:
    - (1) A completed TRPA residential application form.
    - (2) Proof of receipt of a Plan for 1986 allocation.
    - (3) A plot plan, minimum size 18" x 24", showing the property lines, the location of the proposed residence and other improvements, a north arrow, map scale, the APN, topographic contour lines with no more than two foot contour intervals, coverage calculations indicating the amount of proposed coverage, existing and new, by land capability district, and elevations showing the proposed height of the structure, or proposed excavation.
    - (4) An application fee.

- c. TRPA may require the submittal of additional information when it is determined that more information is necessary to adequately review the project under consideration.
5. Before approving any residential project, the Agency shall make the following findings, in addition to any other findings required by applicable Agency ordinances:
  - a. That the project under review shall not adversely affect the implementation of the regional plan.
  - b. That the project shall not cause the environmental threshold carrying capacities to be exceeded.
6. Upon review and approval by TRPA, applicants shall be issued a permit.
  - a. Permits shall be issued on a form provided by TRPA and shall be signed by the Executive Director or his designee. Permits shall be mailed or delivered to the permittee no later than the fifth working day following approval. Copies of permits issued shall be sent to the appropriate county or city.
  - b. Permits shall state:
    - (1) The standard conditions of approval, Exhibit "A" to this resolution, shall be included by reference and special conditions shall be set forth on the permit.
    - (2) The expiration date of the approval.
    - (3) That the owner shall be held responsible for any and all permit conditions.
    - (4) That actual construction shall not commence until all pre-construction conditions of approval are satisfied.
    - (5) No construction shall commence until TRPA receives a copy of the permit upon which the permittee(s) has acknowledged receipt of a copy of the permit and understanding and acceptance of the contents of the permit. Acknowledgements should be returned within twenty (20) days of the mailing or delivery of the permit.
7. One extension of one year may be granted to the two (2) year construction completion schedule required as a standard condition of approval, provided the request is made in writing prior to the expiration of the two (2) year schedule and the Agency finds as follows:
  - a. The residence, though not completed, has been otherwise pursued as evidenced by substantial construction of the residence each building season (May 1 - October 15) since commencement of construction.
  - b. That good cause exists for the extension.

8. No extensions of the project approval shall be granted except for extensions given for the period of time a project is the subject of a legal action which delays or renders diligent pursuit of that project impossible.
9. Transfers of Plan for 1986 allocations shall be approved by TRPA. Although an allocation may be approved for transfer more than once, only one complete transfer shall be permitted per allocation.
  - a. Applications for a transfer shall be made on a form provided by TRPA and shall include proof of receipt of a Plan for 1986 allocation for the transferor parcel and the application fee.
  - b. Upon approval of the transfer TRPA shall issue a notice of approval which shall state the conditions of the transfer, the APN of the transferee lot, and which shall further state that the transfer is not complete until the allocation form is signed by all required parties.
10. Transfers of allocations shall not be deemed completed until the applicant has received a TRPA notice of approval for the transfer and the allocation form has been signed by the owners of the transferor and transferee parcels and the appropriate TRPA official. County approval shall only be required for intercounty transfers.
11. Any Plan for 1986 allocation, with the exception of the "prior approvals" (I.B.3. Plan for 1986), which does not have either a complete application on file with the Agency or a completed transfer of allocation, before 5:00 P.M., December 31, 1986, shall be forfeit and surrendered to the county or city of origin.
12. Amendments to the standard conditions of approval for residential projects, attached hereto as Exhibit "A" and incorporated herein by reference, shall be made by resolution of the TRPA Governing Board.
13. Projects classified as "prior approvals" in the Plan for 1986 (I.B.3.) shall not be required to comply with Section 2 above. Such projects, upon compliance with their pre-construction conditions of approval and compliance with the amended regional plan standards for wood stoves, heaters, BMPs and related provisions, shall be issued a permit on the form described in Section 5 above. The expiration date of any permit issued to a "prior approval" shall be calculated so as to include the extension of the three year approval period to which the project is entitled as the subject of the legal action entitled State of California/League to Save Lake Tahoe v. TRPA, which has delayed the diligent pursuit of the project since May 1, 1984.
14. Approvals of residences under the Plan for 1986 may be appealed by filing a written notice or request for appeal with TRPA no later than twenty (20) days after the issuance of the permit. An appeal shall not automatically stay the permit. The appellant may request, as part of the written notice of appeal, a stay of the permit and any such request shall include credible evidence of the need for a stay pending a hearing on the appeal before the

Governing Board at its next regular meeting. The Chairman of the Governing Board shall review any request for a stay of a permit and the evidence submitted therewith, and shall determine whether or not a stay of the permit shall issue. Appeals shall be scheduled for the upcoming Governing Board meeting provided the Agency is able to give proper notice of the appeal.

TAHOE REGIONAL PLANNING AGENCY  
STANDARD CONDITIONS OF APPROVAL FOR RESIDENTIAL PROJECTS

A. The following conditions shall be satisfied prior to commencement of any construction activity on the project site, including but not limited to, grading, excavation, and clearing of trees. Failure to satisfy these conditions of approval prior to commencement of construction activity shall be grounds for revocation of the permit.

1. The permittee shall submit final construction drawings and a plan(s) showing revegetation, slope stabilization, and drainage improvements. Revegetation, slope stabilization and drainage improvement plans shall be designed in conformance with the Lake Tahoe Basin Water Quality Management Plan, Volume II, Handbook of Best Management Practices.

a. The final construction drawings shall include equipment specifications in conformance with the following:

- (1) Water conservation devices shall be used on all fixtures.
- (2) Gas water heaters shall not emit nitrogen oxides greater than forty (40) nanograms of nitrogen oxide (as  $\text{NO}^2$ ) per joule of heat output at sea level.
- (3) Gas space heaters shall not emit nitrogen oxides greater than forty (40) nanograms of nitrogen oxide (as  $\text{NO}^2$ ) per joule of useful heat delivered to the heated space at sea level.
- (4) Only airtight woodstoves and fireplace inserts, with secondary combustion chambers, or other devices of similar efficiency shall be installed. The minimum acceptable level of technology shall be either a freestanding airtight woodstove or a fireplace insert which contains: an outside or underhome source of combustion air, airtight doors, and a heat exchanger with an electric fan assist to promote convection.
- (5) Woodstoves and fireplace inserts should be operated to minimize particulate emissions. Use only dry, seasoned wood; operate the unit with the doors closed (except when starting the fire); and do not allow a fire to smolder in the unit in a choked condition.
- (6) A list of acceptable and recommended gas space and water heaters and woodstoves and fireplace inserts is available from TRPA.

b. Revegetation plans shall show areas to be revegetated, specifications for revegetation, and fencing for vegetation protection. Only native species adaptable to the Lake Tahoe Basin shall be used for landscaping or revegetation. A list of acceptable species is available from TRPA.



- c. Slope stabilization plans shall show all methods of stabilization to be used to stabilize all existing and proposed cut and fill slopes and areas otherwise denuded of vegetation. Said plans shall also show temporary and permanent erosion control devices and measures to be taken for dust control.
  - d. Drainage plans shall show all drainage facilities for all existing and proposed impervious surfaces and utility trenches. Drainage facilities shall be designed to be capable of retaining runoff waters for a two (2) year, six (6) hour storm. Calculations demonstrating the proposed facilities' retention capabilities may be required. Whenever possible, utilities shall occupy common trenches to minimize site disturbance.
2. The above plans shall require TRPA review to determine their compliance with the conditions set forth above and with the approved plot plan. Plans determined to be in compliance shall be so designated by TRPA and shall be incorporated as part of the approval and permit.
  3. Security shall be posted with TRPA to insure compliance with the conditions of the permit. The security shall be determined by TRPA and shall be the amount equal to 150% of estimated costs of the revegetation, drainage improvements and slope stabilization plans.
  4. The permittee shall submit the required air and water quality mitigation fees.
  5. All local government and other public agency approvals and permits shall be obtained by the permittee.
  6. Prior to any grading activity commencing, the permittee shall contact TRPA and arrange for a pregrading inspection to verify that all temporary erosion control measures and protective fencing for vegetation are in place.
  7. The permittee shall return a copy of the permit form acknowledged by the permittee(s) stating that the permit was received and that the permit is understood and the contents are accepted. Acknowledgements should be returned within twenty (20) days of mailing or delivery of the permit.
- B. The following conditions shall apply to construction activity on the site:
1. There shall be no grading, filling, clearing of vegetation or other disturbance of the soil onsite between October 15 and May 1 of each year.
  2. There shall be no grading, filling, clearing of vegetation or other disturbance of the soil during inclement weather and during the resulting period of time when the site is covered with snow or is saturated, muddy or unstable.

3. All material obtained from excavation work shall be either contained within the foundations, retaining walls or by a similar approved means, shall be stabilized and revegetated within one year, or shall be disposed of at a site approved by TRPA.
4. Soil and construction material shall not be tracked offsite. Grading operations shall cease in the event a danger of violating this condition exists. The site shall be cleaned and the road right-of-way shall be swept clean when necessary.
5. The length of open trenches (excluding foundations) shall not exceed fifty (50) feet at the end of each working day.
6. Loose soil mounds or surfaces shall be protected from wind and water erosion by being appropriately covered or contained when active construction is not occurring.
7. All excavated material shall be stored up grade from excavated areas. No material shall be stored in stream environment zones or other wet areas.
8. Equipment of a size and type that will do the least amount of damage to the environment shall be used. Cleaning of equipment, including cement mixers, shall be permitted if contained on the property and the affected area is revegetated.
9. Vehicles or heavy equipment shall not be allowed in stream environment zones or other wet areas unless specifically authorized by TRPA. All vehicles and heavy equipment shall be confined to the area within the vegetative protection fencing unless specifically authorized by TRPA.
10. Replanting of all exposed surfaces, as shown on the revegetation and slope stabilization plans, shall be completed within one year following the commencement of construction.
11. All trees and natural vegetation which is to remain shall be fenced for protection. Scarring of trees shall be avoided. Scarred trees shall be repaired with tree seal.
12. Revegetation of compacted dirt areas not to be surfaced shall include seedbed preparation in accord with Chapter XI, Section D, of the Handbook of Best Management Practices.
13. At all times during construction, environmental protection and control devices shall be maintained in a functioning state. Such devices include, but are not limited to, dust control devices and vegetative protection.

14. No grading, filling, clearing of vegetation, operation of equipment or disturbance of the soil shall take place in areas where any historic or prehistoric ruins or monuments or objects of antiquity are present or could be damaged by grading. If any historic or prehistoric ruins or monuments or objects of antiquity are discovered all grading, filling, clearing of vegetation, operation of equipment or disturbance of the soil shall cease until a recovery plan is approved by the TRPA.
15. All construction sites shall be winterized no later than October 15 of each year as follows:
  - a. Inactive winter sites shall contain erosion and drainage improvements necessary to prevent discharge from the site including, but not limited to:
    - (1) Installation of temporary erosion controls;
    - (2) Installation of temporary protective fencing of vegetation;
    - (3) Stabilization of all disturbed areas;
    - (4) Cleanup and removal of all construction slash and debris;
    - (5) Installation of permanent mechanical stabilization and drainage improvements, where feasible;
    - (6) Removal or stabilization of spoil piles.
  - b. Active winter sites shall comply with the following:
    - (1) Installation of all permanent mechanical erosion control devices, including paving of all driveway and parking areas;
    - (2) Installation of all permanent drainage improvements;
    - (3) Parking of vehicles, equipment and storage of materials shall be restricted to paved areas.
16. Work shall be performed in such a manner that the project can be winterized within twenty-four (24) hours.
17. Rehabilitation and cleanup of the site following construction shall include, but not be limited to, removal of all construction waste and debris.
18. The TRPA permit and the final construction drawings shall be present onsite from the time construction commences until the final TRPA site inspection.
19. Upon completion of all the project, as a condition of the release of the security, TRPA shall conduct a final site inspection to verify that all required improvements and revegetation are properly installed and that all the conditions of the permit have been satisfied.

20. The residence shall be complete within two (2) years of commencement of construction. A complete residence shall consist of a finished shell and roof. All permanent drainage improvements, slope stabilization and revegetation shall be complete. Permittees may apply for a one-time-only one (1) year extension of the two year completion condition. Application shall be made prior to the expiration of the two year period.
21. The permittee shall allow TRPA to enter and inspect the site at any time to determine compliance with the permit.
22. VIOLATION OF ANY OF THE ABOVE CONDITIONS SHALL BE GROUNDS FOR REVOCATION OF THE PERMIT. FAILURE TO COMMENCE CONSTRUCTION WITHIN THE APPROVAL PERIOD SHOWN ON THE PERMIT FACE OR FAILURE TO DILIGENTLY PURSUE CONSTRUCTION WITHIN THE TWO YEAR COMPLETION PERIOD SHALL RESULT IN THE EXPIRATION OF THE PERMIT, WITHOUT NOTICE, BY OPERATION OF LAW, ON THE DATE SHOWN ON THE PERMIT FACE. [REDACTED]

# TAHOE REGIONAL PLANNING AGENCY

P.O. Box 1038  
Zephyr Cove, Nevada 89448-1038

195 U.S. Highway 50  
Round Hill, Zephyr Cove, NV

(702) 588-4547

## MEMORANDUM

April 15, 1986

To: The TRPA Governing Board

From: The Staff

Subject: Authorization of Legal Counsel to Obtain Exemption  
from Injunction for Vested Rights Determinations

Counsel will be prepared to report on the progress of these negotiations at the meeting.

SES:jf  
4/15/86

AGENDA ITEM VI C.

TAHOE REGIONAL PLANNING AGENCY  
STAFF SUMMARY

Project Name: Continental Telephone Company, Pharris Lane Conduit Extension

Application Type: Public Works

Applicant: Continental Telephone

Location: The subject project is located along Pharris Lane (old Highway 50) north from Lakeshore Boulevard to the north side of the entrance into the Presbyterian Campground, Douglas County.

Assessor's Parcel Number: 560-100-00

Land Use District: Low Density Residential

Land Capability Classification: Land Capability 1a and 5

Plan Area Statement: 067, Marla Bay/Zephyr Heights, Residential/Mitigation

Review Per Section:

1. Subparagraph 1(d) Third Order Amending Order Granting Preliminary Injunction.
2. Section 3.00, Ordinance 84-1 (Article V(g) Findings).
3. Section 4.30 (2), Ordinance 84-1, Review of Other Pending Projects.
4. Section 4.31 (1) and (2), Ordinance 84-1 (Review Criteria).
5. Section 7.12 (Public Works Projects) TRPA Land Use Ordinance.

Project Description: Continental Telephone Company proposes to install 2,210 linear feet of underground telephone conduit system in Pharris Lane north from Lakeshore Boulevard to the north side of the entrance into the Presbyterian Campground. All work will be within the confines of the Marla Bay Improvement District and the Presbyterian Campground properties.

The underground telephone conduit system will provide service to existing residences within the Marla Bay Improvement District.

Other Agency Approvals: Marla Bay Improvement District Encroachment Permit.

Staff Analysis: Continental Telephone's conduit system will help alleviate overcrowding from an overstressed pole line which exists along Pharris Lane through the Presbyterian Campground. Continental will retain one aerial cable system within the existing right-of-way.

The conduit system consists of four 5" I.D. conduits configured two wide and two high and will extend along the easterly side of Pharris Lane northerly from an existing manhole located in Lakeshore Boulevard at Pharris Lane. The conduit will be placed in a trench 24"( $\pm$ ) wide, and 42"( $\pm$ ) deep while maintaining a minimum cover of 30". The asphalt pavement will be saw cut and an eight foot (8') strip will be removed and replaced. Two manholes will be placed in the paved area. The sizes being: 4'6"W. 8'6"L. 6'6"D. and 4'6"W. 8'6"L. 5'6"D. The total square footage of asphalt being replaced is 10,500. Lineal footage in paved area is 1,300. The remainder of the area traversed by this conduit system will be located on private property, the lineal footage being 910'. Two manholes each being 4'6"W. 8'6"L. 5'6"D. will be installed. Total lineal footage for this project is 2,210 feet.

All restoration work will be in accordance with Marla Bay Improvement District and Douglas County specifications and standards.

Land Capability District/Land Coverage: Approximately 70% of the project site is located within land capability district 1a, the remaining 30% of the project is located within district 4.

Article V(g) Findings (Section 3.00, Ordinance 84-1): The following is a list of the V(g) findings as set forth under Section 3.00 of Ordinance 84-1. Following each finding, Agency staff has briefly summarized the evidence on which the required finding may be made.

1. The project is consistent and complies with the CTRPA and Agency ordinance, maps, rules, regulations and policies in effect on August-25, 1983 where said ordinances, maps, rules, regulations and policies are not inconsistent or in conflict with the amendments to the Regional Plan adopted by this ordinance. In the event said ordinances, maps, rules, regulations or policies are inconsistent or in conflict with said amendments to the Regional Plan, the Agency shall find that the project is consistent and complies with said amendments to the Regional Plan.

This project is being reviewed under Section 7.12 TRPA Land Use Ordinance and is consistent and complies with the amendments to the Regional Plan.

2. The project has been processed in accordance with the Agency's Rules and Regulations of Practice and Procedure.

The project is properly before the Governing Board for consideration. Proper application and fees have been submitted.

3. With respect to projects for which an environmental impact statement has not been prepared, the project, including compliance with the conditions of approval, will not have an adverse significant, individual or cumulative impact on the environment.

An environmental checklist has been completed for the project and our analysis concludes that the project will not have an adverse, significant, or cumulative impact on the environment.

4. The establishment, maintenance and operation of the project will not be detrimental to the health, safety, peace, comfort or general welfare of the Lake Tahoe Region.

There is no evidence suggesting that the project will be detrimental to the health, safety, peace, comfort, or general welfare of the Lake Tahoe Region.

5. The project is consistent with the goals and policies of the Water Quality, Transportation and Air Quality, Conservation, Recreation, Public Services and Facilities and Implementation Elements of the Regional Plan, as amended.

- a. Water Quality - The project includes mitigation measures to ensure compliance with the TRPA 208 Water Quality Plan.
- b. Transportation and Air Quality - The project does not propose any work which will be in conflict with the Transportation and Air Quality Element of the amended Regional Plan.
- c. Conservation - The project does not propose any work which will be in conflict with the Conservation Element of the amended Regional Plan.
- d. Public Services and Facilities - The project is consistent with the goals and policies of the Public Services and Facilities Element of the amended Regional Plan.
- e. Implementation - The project is consistent with the development and implementation priorities set forth in the Implementation Element of the amended Regional Plan.
- f. Preliminary Injunction - The Preliminary Injunction contains a specific exemption for this project.

Required Actions and Findings:

To approve the project, the Governing Board must take the following actions and make the following findings:

- I. A motion for a finding of no significant environmental effect, based on the staff report of 4-2-86, with direction to staff to prepare the necessary certification document to be included with the permit.



II. A motion for approval of the project, as described in the staff report of 4-2-86, based on the following findings and conditions which are to be included in writing of the permit:

A. Findings

1. The V(g) findings listed on Attachment K.
2. The project will not adversely affect implementation of the Regional Plan or cause the environmental threshold carrying capacities to be exceeded.

B. Conditions:

1. The standard conditions listed on Attachment D with the following modifications:

Delete the following conditions as they do not apply:

- 1a. Revegetation and slope stabilization plans.
- 1c. Civil Engineer calculations.
- 1e. Site improvement drawing.
3. Utilities in common trenches.
20. Water conservation devices.
21. Water heaters.
22. Space heaters.
23. Air tight stoves.

Add the following conditions:

37. The security referred to in Condition 1(b) shall be \$500.
38. All areas disturbed during construction, that are not to be resurfaced, shall be revegetated according to a schedule to be approved by staff, and in accordance with Chapter XI, Section D of the Handbook of Best Management Practices.
39. Telephone conduit utility trenches shall not be constructed in any flowing waterways.

RECEIVED

BY \_\_\_\_\_

FEB 26 1986

TAHOE REGIONAL  
PLANNING AGENCY

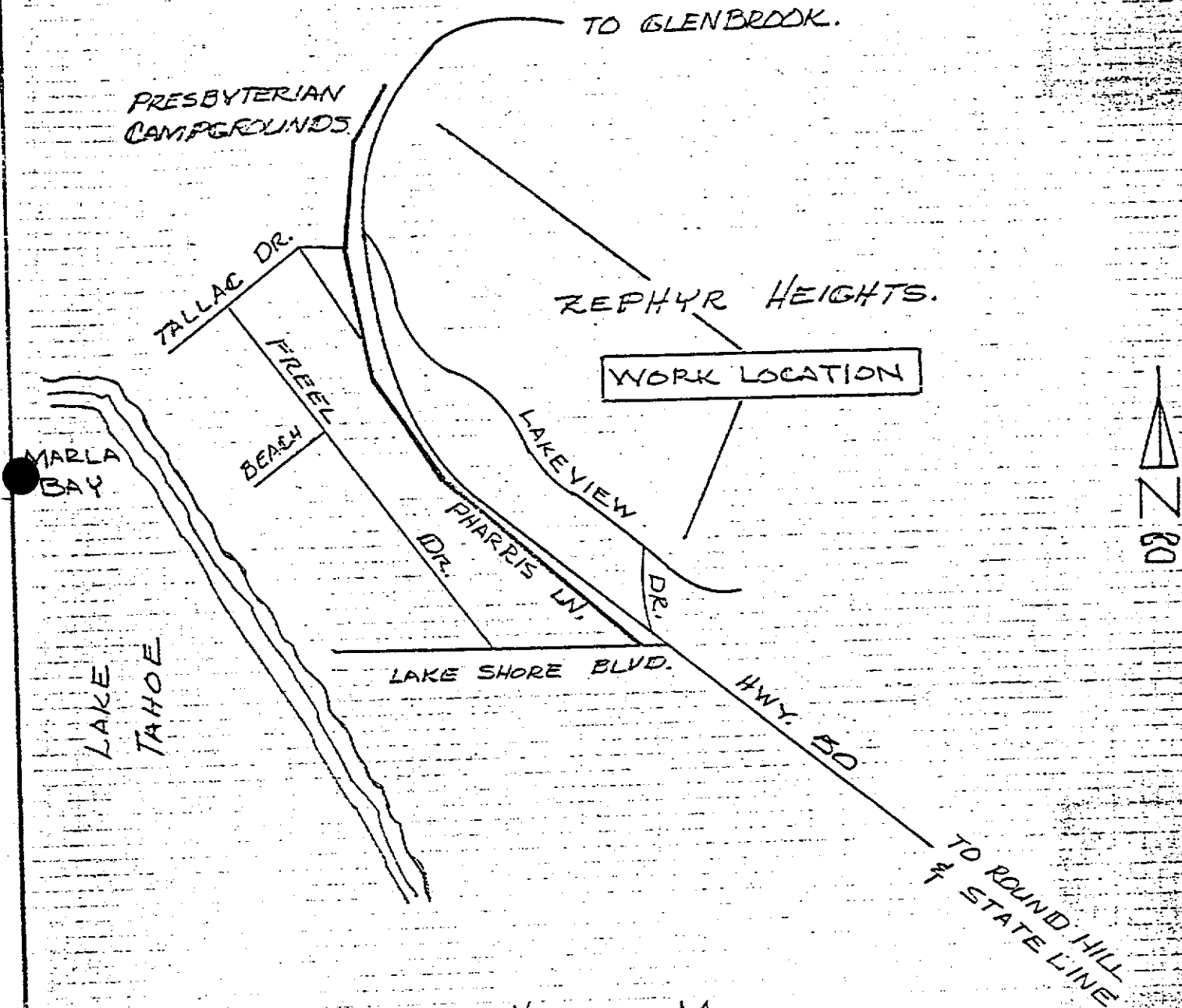

VICINITY MAP.

TITLE UNDERGROUND CONDUIT & CABLE PHARRIS (HWY. 50) NORTH OF LAKE SHORE BLVD.		SCALE <i>Handwritten symbol</i>	DATE 1-31-85
COMPANY Continental Telephone Company of California		PREPARED BY <i>Handwritten initials</i>	APPROVED BY <i>Handwritten initials</i>
STATE LINE	EXCHANGE	DRAWING OF JOB ORDER NUMBER E5213-01	ISSUE
Continental Telephone LOCATION		SHEET 1 OF 6 SHEETS	

A

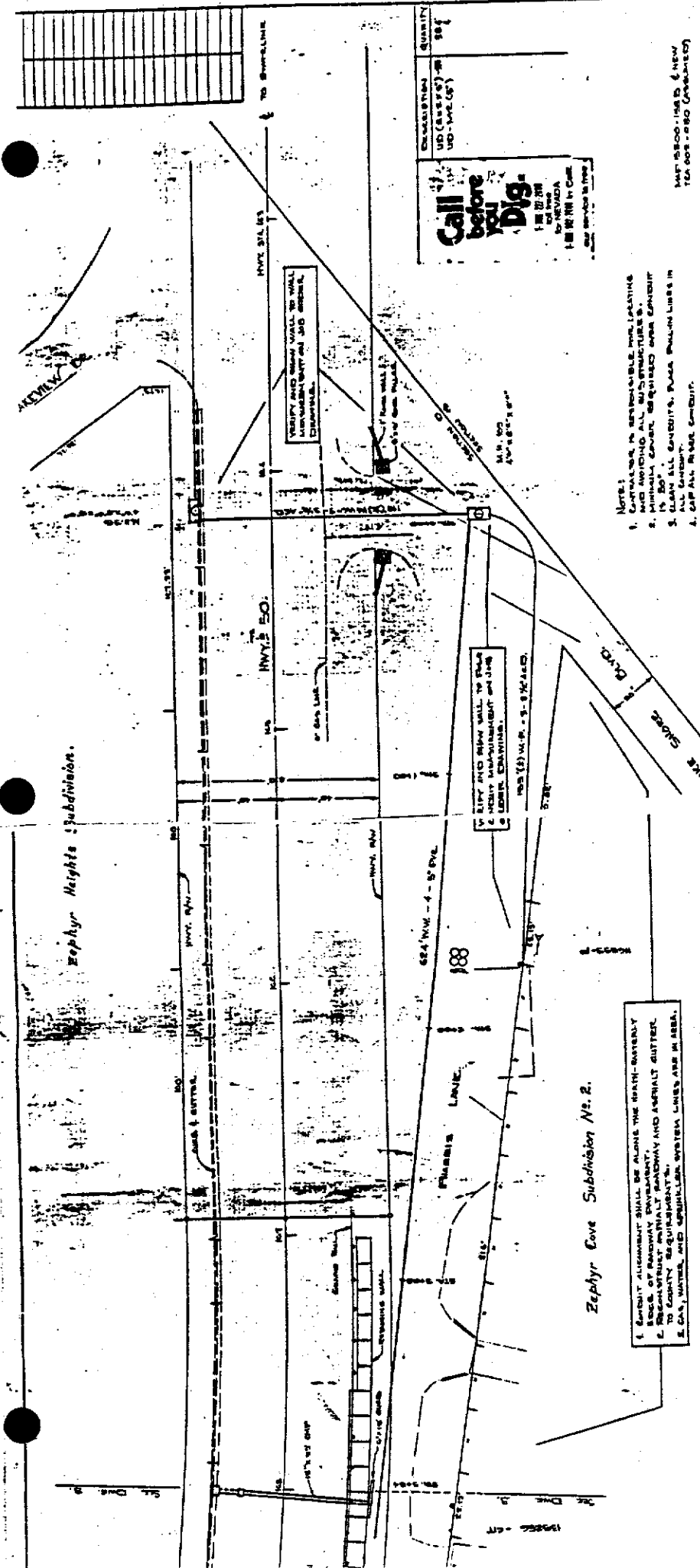

**Call before you Dig**

1-800-4-A-DIG  
 1-800-427-4343  
 1-800-4-A-DIG  
 1-800-427-4343

- NOTE:
1. CONTRACTOR IS RESPONSIBLE FOR OBTAINING ALL NECESSARY PERMITS.
  2. MINIMUM COVER REQUIRED UNDER EXISTING IS 18" TO 24" MINIMUM.
  3. CLEAR ALL EXISTING, PAVED, PAVED LINES IN AREA.
  4. SEE ALL OTHER CONDITIONS.

EXISTING ALIGNMENT SHALL BE ALONG THE NORTH-SOUTHLY EDGE OF PAVED DRIVEWAY AND AERIAL OUTLET. EXISTING PAVEMENT, GAS, WATER, AND SEWER LINES ARE IN AREA.

VERIFY AND SHOW WALL TO WALL MAINTENANCE AND JOBS UNDER CONTRACT.

DESCRIPTION	QUANTITY
UD (ASBESTOS) - 18"	100
UD (ASBESTOS) - 24"	100

PROJECT C/N	DATE
WATER LINE	1988
1888 PAROLA DAY	
EXTENSION FROM THE LU (FROM '80) SOUTH OF LIFE SLOPE	
ECK 13-01	
DATE: 12-15-88	BY: [Signature]

**Call before you Dig.**  
 1-800-4-A-DIG  
 1-800-4-2746  
 1-800-4-2746  
 Our service is free.

DESCRIPTION	QUANTITY	UNIT
CONCRETE	100.00	CU YD
REINFORCING BARS	100.00	LB
FORMWORK	100.00	SQ YD
PIPE	100.00	LINEAL FT
BRICK	100.00	SQ YD

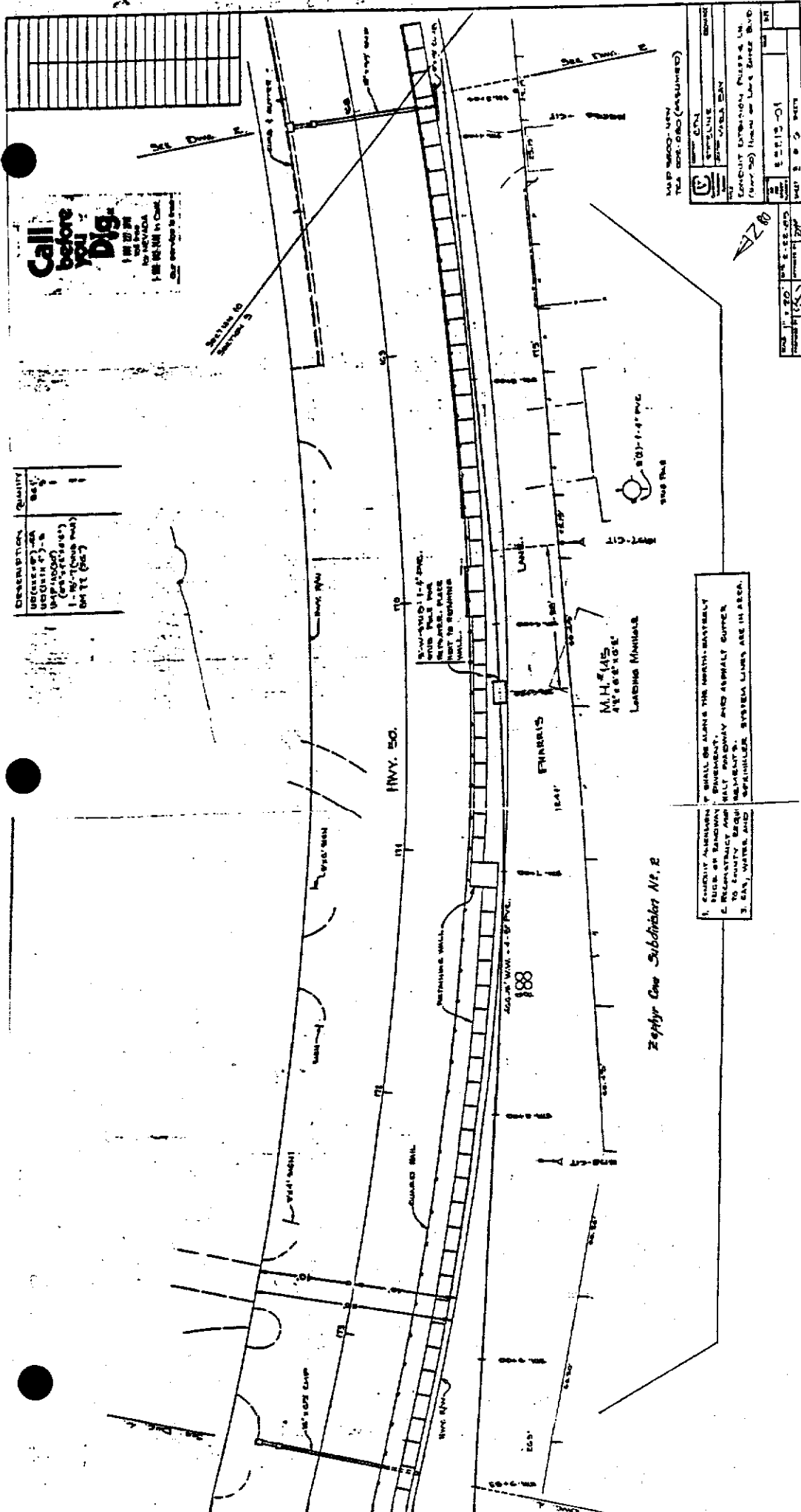

MAP 1000-NEW  
 TLA 002-080 (REQUIRED)

DATE	10-15-01
BY	SS
CHECKED BY	SS
SCALE	AS SHOWN
PROJECT	1000-NEW
DATE	10-15-01

CONCRETE ESTIMATING SERVICE, INC.  
 (HOURS 800) 1000-NEW Lane 2000 Blvd

1. CONCRETE REINFORCING SHALL BE ALONG THE NORTH-EASTERNLY END OF EACH MANHOLE ENSEMBLY.  
 2. REINFORCING AND ASPHALT BUTTER SHALL BE TO COUNTY SPECIFICATIONS.  
 3. SAND, WATER AND SPRINKLER SYSTEM LINES ARE IN AREA.

Zephyr Csw Substation No. 2



188

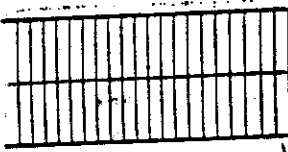

**Call before you Dig.**  
 (800) 4-A-DIG  
 (800) 4-2644  
 For Nevada  
 Call 1-800-4-A-DIG  
 For California  
 Call 1-800-4-A-DIG

Call (800) 4-A-DIG  
 (800) 4-2644  
 (800) 4-A-DIG

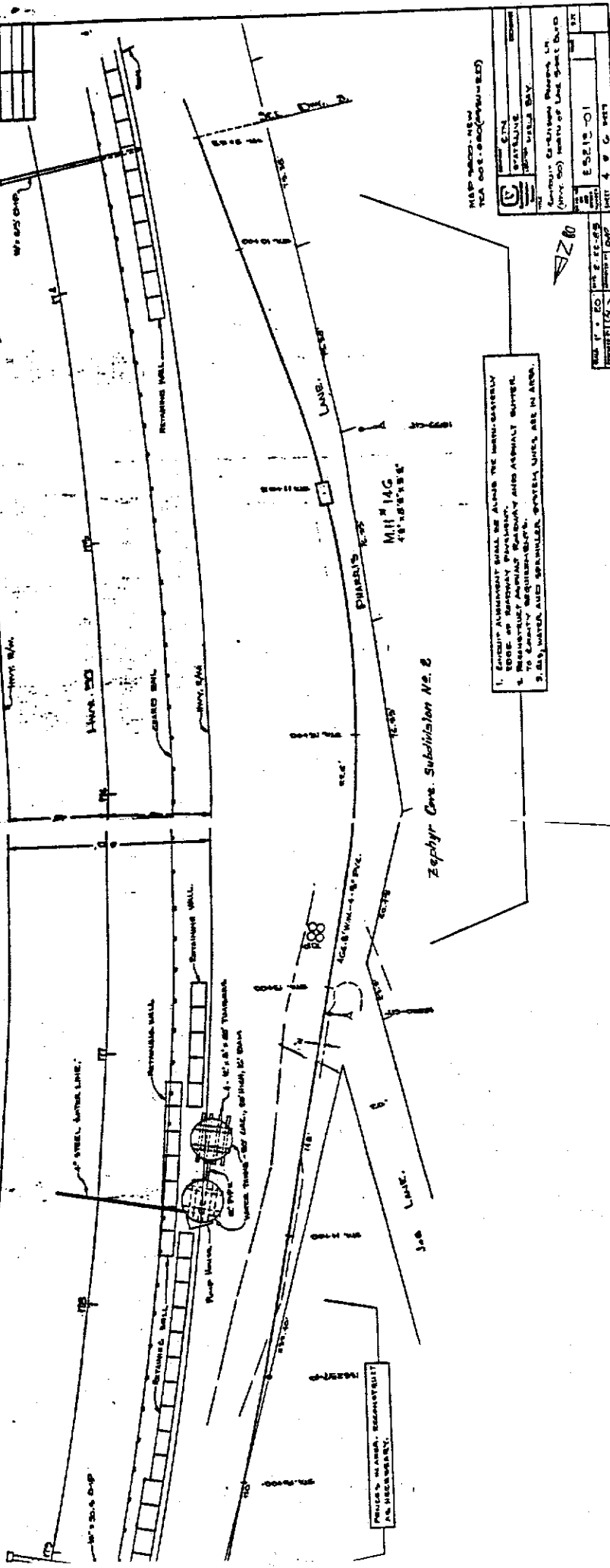

1. GROUND ANCHORAGE SHALL BE ALONG THE MAIN GATEWAY  
 2. BRIDGE SHALL BE CONCRETE  
 3. BRIDGE SHALL BE 40' WIDE AND 10' HIGH  
 4. BRIDGE SHALL BE 40' WIDE AND 10' HIGH  
 5. BRIDGE SHALL BE 40' WIDE AND 10' HIGH  
 6. BRIDGE SHALL BE 40' WIDE AND 10' HIGH

MAP NO. 1000 - NEW  
 TCA 005.000(0000000000)

DATE: 12/15/01  
 DRAWN BY: [Name]  
 CHECKED BY: [Name]  
 PROJECT: [Name]

Scale: 1" = 100'

Sheet: 4 of 6

PROVIDE AN AREA, DIMENSIONS AND PERIMETER.

**Call before you Dig.**  
 1-800-4-A-DIG  
 1-800-4-2-6842  
 24 HOURS A DAY  
 7 DAYS A WEEK  
 1-800-4-2-6842  
 1-800-4-2-6842

DESCRIPTION	NO.	DATE
100 (BRAIN)	1	1
100 (BRAIN)	1	1
100 (BRAIN)	1	1
100 (BRAIN)	1	1
100 (BRAIN)	1	1

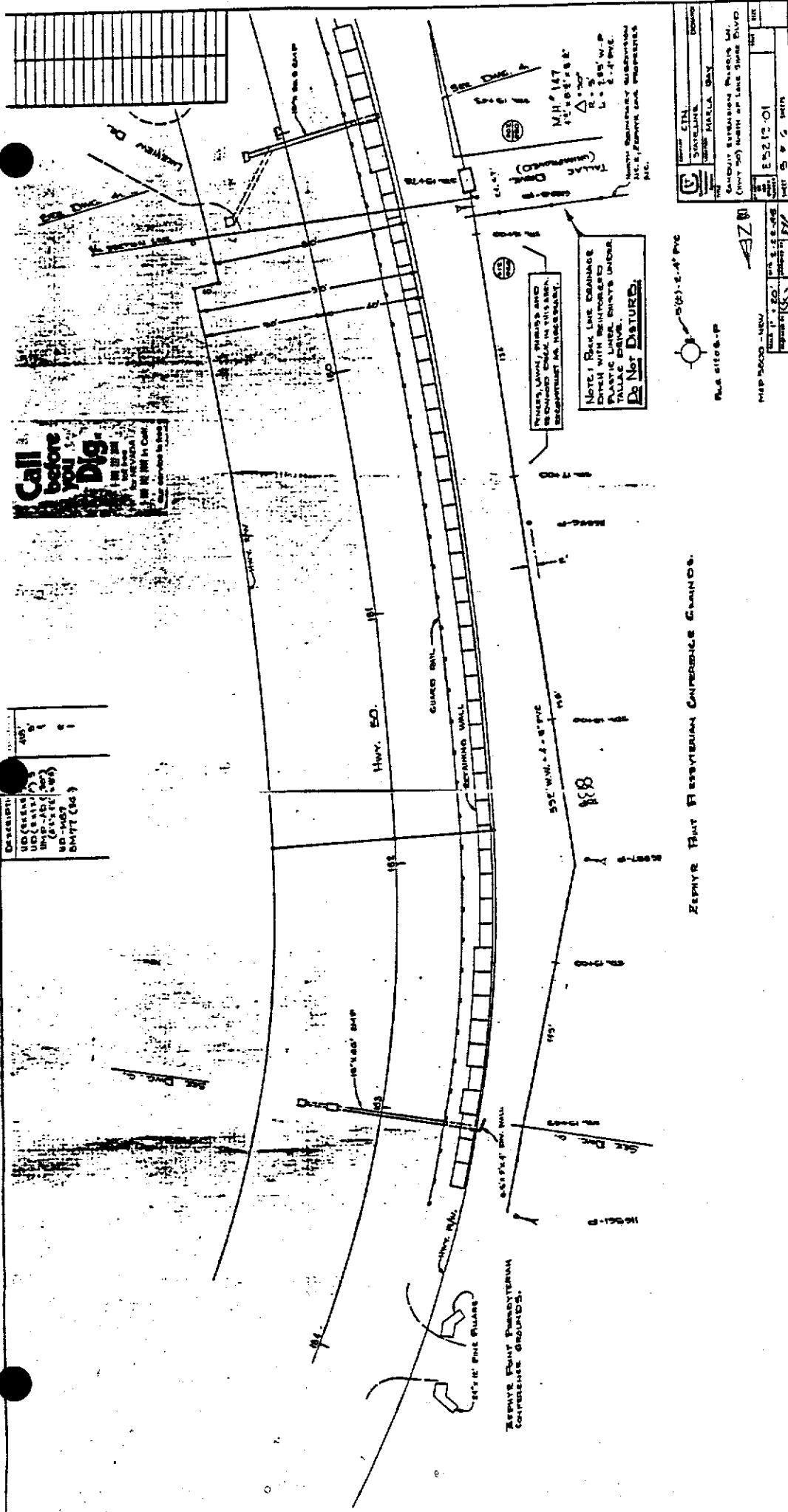

DATE	11/17/88
TIME	10:00 AM
PROJECT	REINFORCED PLASTIC LINED DRAIN UNDER TALKIE DRIVE
LOCATION	100' W. OF MIL 117
SCALE	1/4\"/>

FILES, LAMPS, SHIPS AND REINFORCED CONCRETE IN THIS AREA. REINFORCEMENT IS INDICATED. DO NOT DISTURB.

NOTE: REINFORCED PLASTIC LINED DRAIN UNDER TALKIE DRIVE.

DO NOT DISTURB.

SCALE: 1/4\"/>

ZEPHYR THAT FERRETERIAN CARTRIDGE GRANDS.

DATE	11/17/88
TIME	10:00 AM
PROJECT	REINFORCED PLASTIC LINED DRAIN UNDER TALKIE DRIVE
LOCATION	100' W. OF MIL 117
SCALE	1/4\"/>



TAHOE REGIONAL PLANNING AGENCY

FEB 26 1986

ENVIRONMENTAL CHECK LIST FOR  
THE INITIAL DETERMINATION OF ENVIRONMENTAL IMPACT TAHOE REGIONAL  
PLANNING AGENCY

I PROJECT NAME OR IDENTIFICATION Conduit extension Pharris Lane (Hwy 50) North of  
Lakeshore Blvd. E5213-01

II ENVIRONMENTAL IMPACTS - The following questionnaire will be completed by the applicant based on evidence submitted with the application. All "yes" and "no, with mitigation" answers will require further written comments. See Section III of this questionnaire.

1. Land.	Will the proposal result in:	<u>Yes</u>	<u>No</u>	<u>No, With Mitigation</u>	<u>Data Insufficient</u>
a.	Compaction or covering of the soil beyond the limits prescribed in the land capability system?	_____	<u>X</u>	_____	_____
b.	A change in the topography or ground surface relief features of site inconsistent with the natural surrounding conditions?	_____	<u>X</u>	_____	_____
c.	Unstable earth conditions during or after completion of the proposal?	_____	<u>X</u>	_____	_____
d.	Changes in the soil or geologic substructures?	_____	<u>X</u>	_____	_____
e.	The continuation of or increase in wind or water erosion of soils, either on or off the site?	_____	<u>X</u>	_____	_____
f.	Changes in deposition or erosion of beach sand, or changes in siltation, deposition or erosion which may modify the channel of a river or stream or the bed of a lake?	_____	<u>X</u>	_____	_____
g.	Exposure of people or property to geologic hazards such as earthquakes, landslides, mudslides, ground failure, or similar hazards?	_____	<u>X</u>	_____	_____



	<u>Yes</u>	<u>No</u>	<u>No, With Mitigation</u>	<u>Data Insufficient</u>
2. <u>Air.</u> Will the proposal result in:				
a. Substantial air emissions or deterioration of ambient air quality?	_____	X _____	_____	_____
b. The creation of objectionable odors?	_____	X _____	_____	_____
c. Alteration of air movement, moisture or temperature, or any change in climate, either locally or regionally?	_____	X _____	_____	_____
3. <u>Water.</u> Will the proposal result in:				
a. Changes in currents, or the course or direction of water movements?	_____	X _____	_____	_____
b. Changes in absorption rates, drainage patterns, or the rate and amount of surface water runoff so that a 2 yr. 6 hr. storm runoff cannot be contained on the site?	_____	X _____	_____	_____
c. Alterations to the course or flow of 100 year flood waters?	_____	X _____	_____	_____
d. Change in the amount of surface water in any water body?	_____	X _____	_____	_____
e. Discharge into surface waters, or in any alteration of surface water quality, including but not limited to temperature, dissolved oxygen or turbidity?	_____	X _____	_____	_____
f. Alteration of the direction or rate of flow of ground waters?	_____	X _____	_____	_____
g. Change in the quantity of ground waters, either through direct additions or withdrawals, or through interception of an aquifer by cuts or excavations?	_____	X _____	_____	_____
h. Substantial reduction in the amount of water otherwise available for public water supplies?	_____	X _____	_____	_____

	<u>Yes</u>	<u>No</u>	<u>No, With Mitigation</u>	<u>Data Insufficient</u>
i. Exposure of people or property to water related hazards such as flooding and/or wave action from 100 year storm occurrence or seiches?	_____	X _____	_____	_____
4. <u>Plant Life.</u> Will the proposal result in:				
a. Removal of native vegetation in excess of the area utilized for the actual development permitted by the land capability system?	_____	X _____	_____	_____
b. Removal of riparian vegetation or other vegetation associated with critical wildlife habitat?	_____	X _____	_____	_____
c. Introduction of new vegetation that will require excessive fertilizer or water, or will provide a barrier to the normal replenishment of existing species?	_____	X _____	_____	_____
d. Change in the diversity of species, or number of any species of plants (including trees, shrubs, grass, crops, microflora and aquatic plants)?	_____	X _____	_____	_____
e. Reduction of the numbers of any unique, rare or endangered species of plants?	_____	X _____	_____	_____
5. <u>Animal Life.</u> Will the proposal result in:				
a. Change in the diversity of species, or numbers of any species of animals (birds, land animals including reptiles, fish and shellfish, benthic organisms, insects or microfauna)?	_____	X _____	_____	_____
b. Reduction of the number of any unique, rare or endangered species of animals?	_____	X _____	_____	_____
c. Introduction of new species of animals into an area, or result in a barrier to the migration or movement of animals?	_____	X _____	_____	_____

	<u>Yes</u>	<u>No</u>	<u>No, With Mitigation</u>	<u>Data Insufficient</u>
d. Deterioration to existing fish or wildlife habitat?	_____	X _____	_____	_____
6. <u>Noise</u> . Will the proposal result in:				
a. Increases in existing noise levels?	_____	X _____	_____	_____
b. Exposure of people to severe noise levels?	_____	X _____	_____	_____
7. <u>Light and Glare</u> . Will the proposal produce new light or glare inconsistent with the surrounding area?	_____	X _____	_____	_____
8. <u>Land Use</u> . Will the proposal result in a substantial alteration of the present or planned land use of an area?	_____	X _____	_____	_____
9. <u>Natural Resources</u> . Will the proposal result in:				
a. Increase in the rate of use of any natural resources?	_____	X _____	_____	_____
b. Substantial depletion of any non-renewable natural resource?	_____	X _____	_____	_____
10. <u>Risk of Upset</u> . Does the proposal involve a risk of an explosion or the release of hazardous substances (including, but not limited to, oil, pesticides, chemicals or radiation) in the event of an accident or upset conditions?	_____	X _____	_____	_____
11. <u>Population</u> . Will the proposal alter the location, distribution, density, or growth rate of the human population planned for the Region?	_____	X _____	_____	_____
12. <u>Housing</u> . Will the proposal affect existing housing, or create a demand for additional housing?	_____	X _____	_____	_____
13. <u>Transportation/Circulation</u> . Will the proposal result in:				

	<u>Yes</u>	<u>No</u>	<u>No, With Mitigation</u>	<u>Data Insufficient</u>
a. Generation of 100 or more vehicle trips or in excess of 1% of the remaining road capacity?	_____	<u>X</u>	_____	_____
b. Effects on existing parking facilities, or demand for new parking?	_____	<u>X</u>	_____	_____
c. Substantial impact upon existing transportation systems?	_____	<u>X</u>	_____	_____
d. Alterations to present patterns of circulation or movement of people and/or goods?	_____	<u>X</u>	_____	_____
e. Alterations to waterborne, rail or air traffic?	_____	<u>X</u>	_____	_____
f. Increase in traffic hazards to motor vehicles, bicyclists or pedestrians?	_____	<u>X</u>	_____	_____
<b>14. <u>Public Services.</u> Will the proposal have an unplanned effect upon, or result in a need for new or altered governmental services in any of the following areas:</b>				
a. Fire protection?	_____	<u>X</u>	_____	_____
b. Police protection?	_____	<u>X</u>	_____	_____
c. Schools?	_____	<u>X</u>	_____	_____
d. Parks or other recreational facilities?	_____	<u>X</u>	_____	_____
e. Maintenance of public facilities, including roads?	_____	<u>X</u>	_____	_____
f. Other governmental services?	_____	<u>X</u>	_____	_____
<b>15. <u>Energy.</u> Will the proposal result in:</b>				
a. Use of substantial amounts of fuel or energy?	_____	<u>X</u>	_____	_____

	<u>Yes</u>	<u>No</u>	<u>No, With Mitigation</u>	<u>Data Insufficient</u>
b. Substantial increase in demand upon existing sources of energy, or require the development of new sources of energy?	_____	<u>X</u>	_____	_____
16. <u>Utilities.</u> Except for planned improvements, will the proposal result in a need for new systems, or substantial alterations to the following utilities:				
a. Power or natural gas?	_____	<u>X</u>	_____	_____
b. Communications systems?	<u>X</u>	_____	_____	_____
c. Water?	_____	<u>X</u>	_____	_____
d. Sewer or septic tanks?	_____	<u>X</u>	_____	_____
e. Storm water drainage?	_____	<u>X</u>	_____	_____
f. Solid waste and disposal?	_____	<u>X</u>	_____	_____
17. <u>Human Health.</u> Will the proposal result in:				
a. Creation of any health hazard or potential health hazard (excluding mental health)?	_____	<u>X</u>	_____	_____
b. Exposure of people to potential health hazards?	_____	<u>X</u>	_____	_____
18. <u>Aesthetics.</u> Will the proposal result in the obstruction of any scenic vista or view open to the public, or will the proposal result in the creation of an aesthetically offensive site open to the public view?	_____	<u>X</u>	_____	_____
19. <u>Recreation.</u> Will the proposal result in an impact upon the quality or quantity of existing recreational opportunities?	_____	<u>X</u>	_____	_____
20. <u>Archeological/Historical.</u> Will the proposal result in an alteration of a significant archeological or historical site, structure, object or building?	_____	<u>X</u>	_____	_____

ENVIRONMENTAL CHECK LIST-IMPACT

16B.

This work will remove aerial cables from a highly overstressed pole line and place them in an underground conduit system. It will be necessary to retain an aerial cable on the pole line in order to provide subscriber telephone service. Should this work be disallowed the existing pole lines will have to be totally reinforced resulting in replacement of certain existing poles, the placement of additional poles and necessary guying appurtenances.

	<u>Yes</u>	<u>No</u>	<u>No, With Mitigation</u>	<u>Data Insufficient</u>
<b>21. <u>Mandatory Findings of Significance.</u></b>				
a. Does the project have the potential to degrade the quality of the environment, substantially reduce the habitat of a fish population to drop below self-sustaining levels, threaten to eliminate a plant or animal community, reduce the number or restrict the range of a rare or endangered plant or animal or eliminate important examples of the major periods of California or Nevada history or prehistory?	_____	<u>X</u>	_____	_____
b. Does the project have the potential to achieve short-term, to the disadvantage of long-term, environmental goals? (A short-term impact on the environment is one which occurs in a relatively brief, definitive period of time, while long-term impacts will endure well into the future.)	_____	<u>X</u>	_____	_____
c. Does the project have impacts which are individually limited, but cumulatively considerable? (A project may impact on two or more separate resources where the impact on each resource is relatively small, but where the effect of the total of those impacts on the environmental is significant.)	_____	<u>X</u>	_____	_____
d. Does the project have environmental effects which will cause substantial adverse effects on human being, either directly or indirectly?	_____	<u>X</u>	_____	_____

**III DISCUSSION OF ENVIRONMENTAL EVALUATION**

All impacts identified with "yes" answers under Section II should be described below and evaluated as to their significance. All "no, with mitigation" responses require a description of the identified impact and the mitigation measure(s) proposed to mitigate the impact so that there is no significant impact.

IV CERTIFICATION

I hereby certify that the statements furnished above and in the attached exhibits present the data and information required for this initial evaluation to the best of my ability, and that the facts, statements, and information presented are true and correct to the best of my knowledge and belief.

February 25, 1986  
Date

T.J. Callahan  
(name of person completing this form)

*T.J. Callahan*  
(signature of person completing this form)

V DETERMINATION (to be completed by TRPA)

On the basis of this evaluation:

\_\_\_\_\_ The Agency finds the proposed activity to be categorically exempt under Section \_\_\_\_\_ of Ordinance 81-\_\_\_\_\_, prepared in accordance with Article VII(f) of the Tahoe Regional Planning Compact as amended.

\_\_\_\_\_ The Agency finds that the proposed project could not have a significant effect on the environment and a finding of no significant impact will be prepared.

\_\_\_\_\_ The Agency finds that the project could have a significant effect on the environment, but because of the listed mitigation measures which have been added to the project should have no significant effect on the environment and a conditional finding of no significant impact will be prepared.

\_\_\_\_\_ The Agency finds that the proposed project may have a significant effect on the environment and an environmental impact statement will be required.

\_\_\_\_\_  
Date

\_\_\_\_\_  
Signature of Evaluator

\_\_\_\_\_  
Title



TAHOE REGIONAL PLANNING AGENCY  
STAFF SUMMARY

Project Name: C P National Corporation, Meyers Gas Main Extension

Application Type: Public Works

Applicant: C P National Corporation

Location: Meyers Elementary School Area, (Country Club Estates #1 & # 2, Tahoe Broder Estates #1, Tahoe Paradise Units #2 through #6, #17 and #17-A, #18 and #18-A, Juniper Park).

Land Use District: Low Density Residential

Land Capability Classification: Land capability level 1b and 5.

Plan Area Statement: 124, Meyers Residential - Residential/Mitigation.

Review Per Section:

1. Subparagraph 6(c) Fifth Stipulation Amending Order Granting Preliminary Injunction.
2. Section 3.00, (Article V(g) Findings of TRPA Ordinance 84-1.
3. Section 4.30 (2) Review of Other Pending and New Projects of TRPA Ordinance 84-1.
4. Section 4.31 (1) and (2) Review Criteria of TRPA Ordinance 84-1.
5. Section 4.12 (d) (Public Works Projects) California Side Land Use Ordinance.

Project Description: The applicant seeks to install 38,000 linear feet of 2" and 4" natural gas mains to provide service to 250-275 existing single family dwellings.

The specific subdivisions proposed to be served by the project are:

1. Country Club Estates #1 and #2.
2. Tahoe Broder Estates #1.
3. Tahoe Paradise Units #2 through #6.
4. Tahoe Paradise Units #17, #17-A, #18 and #18-A.
5. Tahoe Paradise.

6. Juniper Park.

The total estimated cost for this project will be approximately \$500,000. The planned construction schedule will run from May 1 through October 15, 1986.

Other Agency Approvals:

El Dorado County: Approved Public Works Department,  
Encroachment Permit L84-624

Lahontan: Waste Discharge Requirement,  
Board Order 6-81-85

Environmental Documentation:

Lead Agency: El Dorado County

Document: Negative Declaration

Staff Analysis:

The purpose of this project is to provide service to existing residences of Country Club Estates, Tahoe Broder Estates, Tahoe Paradise and Juniper Park. The 2" and 4" gas mains will be installed in a trench 12" in width and 30" in depth constructed in road shoulders of existing streets. One-half inch service laterals connecting each residence to the 2" or 4" gas mains will be buried in a trench approximately eighteen inches in depth.

Plastic pipeline identification tape will be buried in gas main trenches at a shallow depth to alert any future excavator to the location of the gas main so that potential damage of the main may be averted. Construction methods will incorporate the use of a diesel powered backhoe to excavate all gas main trenches.

With specific regard to trenching operations, the following controlling measures against waste discharge into stream environmental zones will be utilized:

1. All open trenches will be backfilled and compacted to 90% compaction at the close of each construction day.
2. Surplus waste earthen material will be removed and deposited at an approved disposal location.
3. All trenches cut through existing paving will be covered with gravel or cold patches within 24 hours of completion of the trenching operation.

Land Capability District/Land Coverage: Approximately 50% of the project site is located within land capability district 5, the remaining 50% of the project is located within district 1b, Stream Environment Zone (SEZ). The proposed excavation, however is located entirely within existing roadways and will not result in any disturbance to functioning stream environment zone areas. The entire project will be installed below ground surface and will not result in any additional land coverage.

Article V(g) Findings (Section 3.00, Ordinance 84-1): The following is a list of the V(g) findings as set forth under Section 3.00 of Ordinance 84-1. Following each finding, Agency staff has briefly summarized the evidence on which the required finding may be made.

1. The project is consistent and complies with the CTRPA and Agency ordinances, maps, rules, regulations and policies in effect on August 25, 1983 where said ordinances, maps, rules, regulations and policies are not inconsistent or in conflict with the amendments to the Regional Plan adopted by this ordinance. In the event said ordinances, maps, rules, regulations or policies are inconsistent or in conflict with said amendments to the Regional Plan, the agency shall find that the project is consistent and complies with said amendments to the Regional Plan.

The project is being reviewed under Section 4.12(d) California Side Land Use Ordinance and is consistent and complies with the amendments to the Regional Plan.

2. The project has been processed in accordance with the Agency's rules and Regulations of Practice and Procedure.

The project is properly before the Governing Board for consideration. The proper application and fees have been submitted.

3. With respect to projects for which an environmental impact statement has not been prepared, the project, including compliance with the conditions of approval, will not have an adverse significant, individual or cumulative impact on the environment.

An environmental checklist has been completed for the project and our analysis concludes that the project will not have an adverse, significant, or cumulative impact on the environment.

4. The establishment, maintenance and operation of the project will not be detrimental to the health, safety, peace, comfort or general welfare of the Lake Tahoe Region.

There is no evidence suggesting that the project will be detrimental to the health, safety, peace, comfort, or general welfare of the Lake Tahoe Region.

5. The project is consistent with the goals and policies of the Water Quality, Transportation and Air Quality, Conservation, Recreation, Public Services and Facilities and Implementation Elements of the Regional Plan, as amended.
- a. Water Quality - The project includes mitigation measures to ensure compliance with the TRPA 208 Water Quality Plan.
  - b. Transportation and Air Quality - The project does not propose any work which will be in conflict with the Transportation and Air Quality Element of the amended Regional Plan.
  - c. Conservation - The project does not propose any work which will be in conflict with the Conservation element of the amended Regional Plan.
  - d. Public Services and Facilities - The project is consistent with the goals and policies of the Public Services and Facilities Element of the amended Regional Plan.
  - e. Implementation - The project is consistent with the development and implementation priorities set forth in the Implementation Element of the amended Regional Plan.
  - f. Preliminary Injunction - The Preliminary Injunction contains a specific exemption for this project.

Required Actions and Findings:

To approve the project, the Governing Board must take the following actions and make the following findings:

- I. A motion for a finding of no significant environmental effect, based on the staff report of 4-2-86, with direction to staff to prepare the necessary certification document to be included with the permit.
- II. A motion for approval of the project, as described in the staff report of 4-2-86, based on the following findings and conditions which are to be included in writing of the permit:
  - A. Findings:
    - 1. The V(g) findings listed on Attachment K.
    - 2. The project will not adversely affect implementation of the Regional Plan or cause the environmental threshold carrying capacities to be exceeded.

B. Conditions:

1. The standard conditions listed on Attachment D with the following modifications:

Delete the following conditions as they do not apply:

- 1a. Revegetation and slope stabilization plans.
- 1c. Civil Engineer calculations.
- 1e. Site improvement drawing.
3. Utilities in common trenches.
20. Water conservation devices.
21. Water heaters.
22. Space heaters.
23. Air tight stoves.

Add the following conditions:

37. The security referred to in Condition 1(b) shall be \$1,000.
38. All areas disturbed during construction, that are not to be resurfaced, shall be revegetated according to a schedule to be approved by staff, and in accordance with Chapter XI, Section D of the Handbook of Best Management Practices.
39. Gas main utility trenches shall not be constructed in any flowing waterways.

PROPOSED 1986 MEYERS PROJECT AREA

EXHIBIT "B"

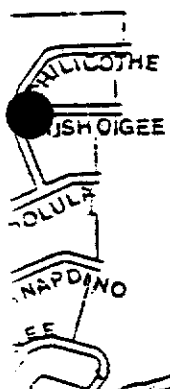
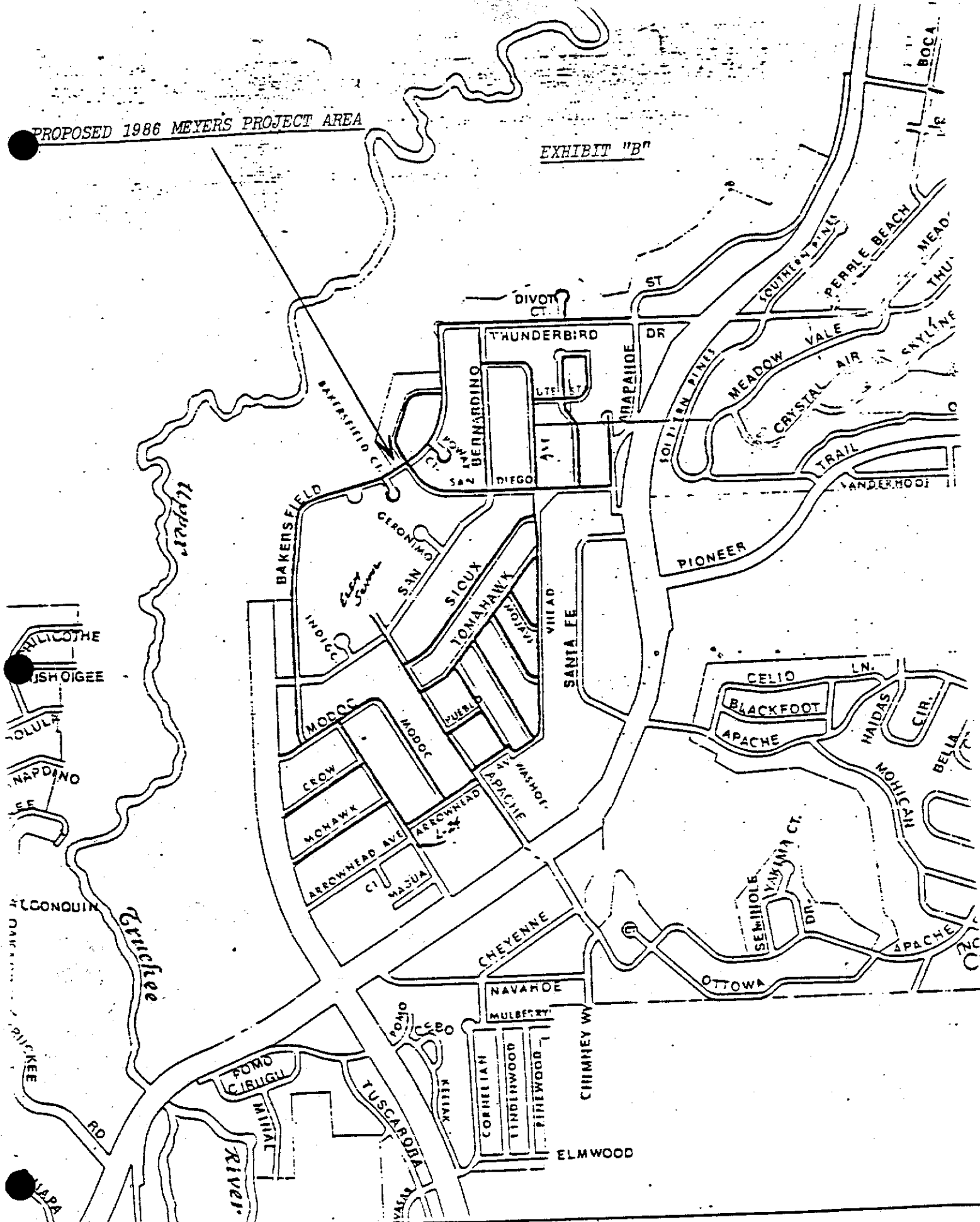
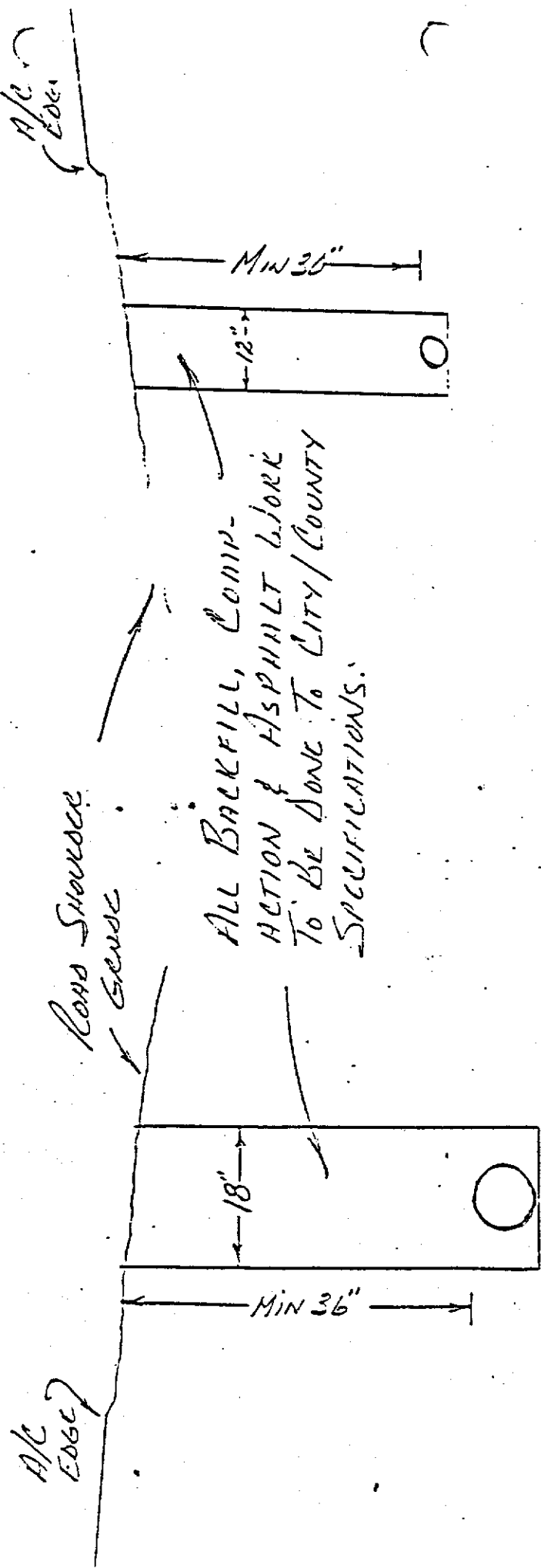

EXHIBIT "A"

TYPICAL CITY/COUNTY  
R/W INSTALLATION  
8" STEEL PIPE

TYPICAL CITY/COUNTY  
R/W INSTALLATION  
2" & 4" PLASTIC PIPE



TAHOE REGIONAL PLANNING AGENCY

ENVIRONMENTAL CHECK LIST FOR  
THE INITIAL DETERMINATION OF ENVIRONMENTAL IMPACT

PROJECT NAME OR IDENTIFICATION Extension of natural gas service to  
Tahoe Paradise Units #2 through #16, #17, #17-A, #18,

ENVIRONMENTAL IMPACTS - The following questionnaire will be completed by the applicant based on evidence submitted with the application. All "yes" and "no, with mitigation" answers will require further written comments. See Section III of this questionnaire. #18-A

1. <u>Land</u> . Will the proposal result in:	<u>Yes</u>	<u>No</u>	<u>No, With Mitigation</u>	<u>Data Insufficient</u>
a. Compaction or covering of the soil beyond the limits prescribed in the land capability system?	_____	<u>X</u>	_____	_____
b. A change in the topography or ground surface relief features of site inconsistent with the natural surrounding conditions?	_____	<u>X</u>	_____	_____
c. Unstable earth conditions during or after completion of the proposal?	_____	<u>X</u>	_____	_____
d. Changes in the soil or geologic substructures?	_____	<u>X</u>	_____	_____
e. The continuation of or increase in wind or water erosion of soils, either on or off the site?	_____	<u>X</u>	_____	_____
f. Changes in deposition or erosion of beach sand, or changes in siltation, deposition or erosion which may modify the channel of a river or stream or the bed of a lake?	_____	<u>X</u>	_____	_____
g. Exposure of people or property to geologic hazards such as earthquakes, landslides, mudslides, ground failure, or similar hazards?	_____	<u>X</u>	_____	_____



	<u>Yes</u>	<u>No</u>	<u>No, With Mitigation</u>	<u>Data Insufficient</u>
<b>2. <u>Air.</u> Will the proposal result in:</b>				
a. Substantial air emissions or deterioration of ambient air quality?	_____	<u>  X  </u>	_____	_____
b. The creation of objectionable odors?	_____	<u>  X  </u>	_____	_____
c. Alteration of air movement, moisture or temperature, or any change in climate, either locally or regionally?	_____	<u>  X  </u>	_____	_____
<b>3. <u>Water.</u> Will the proposal result in:</b>				
a. Changes in currents, or the course or direction of water movements?	_____	<u>  X  </u>	_____	_____
b. Changes in absorption rates, drainage patterns, or the rate and amount of surface water runoff so that a 2 yr. 6 hr. storm runoff cannot be contained on the site?	_____	<u>  X  </u>	_____	_____
c. Alterations to the course or flow of 100 year flood waters?	_____	<u>  X  </u>	_____	_____
d. Change in the amount of surface water in any water body?	_____	<u>  X  </u>	_____	_____
e. Discharge into surface waters, or in any alteration of surface water quality, including but not limited to temperature, dissolved oxygen or turbidity?	_____	<u>  X  </u>	_____	_____
f. Alteration of the direction or rate of flow of ground waters?	_____	<u>  X  </u>	_____	_____
g. Change in the quantity of ground waters, either through direct additions or withdrawals, or through interception of an aquifer by cuts or excavations?	_____	<u>  X  </u>	_____	_____
h. Substantial reduction in the amount of water otherwise available for public water supplies?	_____	<u>  X  </u>	_____	_____
i. Exposure of people or property to water related hazards such as flooding and/or wave action from 100 year storm occurrence or seiches?	_____	<u>  X  </u>	_____	_____

	<u>Yes</u>	<u>No</u>	<u>No, With Mitigation</u>	<u>Data Insufficient</u>
<b>4. <u>Plant Life.</u> Will the proposal result in:</b>				
a. Removal of native vegetation in excess of the area utilized for the actual development permitted by the land capability system?	_____	<u>X</u>	_____	_____
b. Removal of riparian vegetation or other vegetation associated with critical wildlife habitat?	_____	<u>X</u>	_____	_____
c. Introduction of new vegetation that will require excessive fertilizer or water, or will provide a barrier to the normal replenishment of existing species.	_____	<u>X</u>	_____	_____
d. Change in the diversity of species, or number of any species of plants (including trees, shrubs, grass, crops, microflora and aquatic plants)?	_____	<u>X</u>	_____	_____
e. Reduction of the numbers of any unique, rare or endangered species of plants?	_____	<u>X</u>	_____	_____
<b>5. <u>Animal Life.</u> Will the proposal result in:</b>				
a. Change in the diversity of species, or numbers of any species of animals (birds, land animals including reptiles, fish and shellfish, benthic organisms, insects or microfauna)?	_____	<u>X</u>	_____	_____
b. Reduction of the number of any unique, rare or endangered species of animals?	_____	<u>X</u>	_____	_____
c. Introduction of new species of animals into an area, or result in a barrier to the migration or movement of animals?	_____	<u>X</u>	_____	_____
d. Deterioration to existing fish or wildlife habitat?	_____	<u>X</u>	_____	_____
<b>6. <u>Noise.</u> Will the proposal result in:</b>				
a. Increases in existing noise levels?	_____	_____	<u>X</u>	_____
b. Exposure of people to severe noise levels?	_____	<u>X</u>	_____	_____
<b>7. <u>Light and Glare.</u> Will the proposal produce new light or glare inconsistent with the surrounding area?</b>				
	_____	<u>X</u>	_____	_____
<b>8. <u>Land Use.</u> Will the proposal result in a substantial alteration of the present or planned land use of an area?</b>				
	_____	<u>X</u>	_____	_____

<u>Yes</u>	<u>No</u>	<u>No, With Mitigation</u>	<u>Data Insufficient</u>
------------	-----------	----------------------------	--------------------------

9. Natural Resources. Will the proposal result in:

a. Increase in the rate of use of any natural resources?

_____	X	_____	_____
-------	---	-------	-------

b. Substantial depletion of any non-renewable natural resource?

_____	X	_____	_____
-------	---	-------	-------

10. Risk of Upset. Does the proposal involve a risk of an explosion or the release of hazardous substances (including, but not limited to, oil, pesticides, chemicals or radiation) in the event of an accident or upset conditions?

_____	X	_____	_____
-------	---	-------	-------

11. Population. Will the proposal alter the location, distribution, density, or growth rate of the human population planned for the Region?

_____	X	_____	_____
-------	---	-------	-------

12. Housing. Will the proposal affect existing housing, or create a demand for additional housing?

_____	X	_____	_____
-------	---	-------	-------

13. Transportation/Circulation. Will the proposal result in:

a. Generation of 100 or more vehicle trips or in excess of 1% of the remaining road capacity?

_____	X	_____	_____
-------	---	-------	-------

b. Effects on existing parking facilities, or demand for new parking?

_____	X	_____	_____
-------	---	-------	-------

c. Substantial impact upon existing transportation systems?

_____	X	_____	_____
-------	---	-------	-------

d. Alterations to present patterns of circulation or movement of people and/or goods?

_____	X	_____	_____
-------	---	-------	-------

e. Alterations to waterborne, rail or air traffic?

_____	X	_____	_____
-------	---	-------	-------

f. Increase in traffic hazards to motor vehicles, bicyclists or pedestrians?

_____	X	_____	_____
-------	---	-------	-------

<u>Yes</u>	<u>No</u>	<u>No, With Mitigation</u>	<u>Data Insufficient</u>
------------	-----------	----------------------------	--------------------------

14. Public Services. Will the proposal have an unplanned effect upon, or result in a need for new or altered governmental services in any of the following areas:

- |   |       |   |       |       |
|---|-------|---|-------|-------|
| a. Fire protection?                                   | _____ | X | _____ | _____ |
| b. Police protection?                                 | _____ | X | _____ | _____ |
| c. Schools?   | _____ | X | _____ | _____ |
| d. Parks or other recreational facilities?            | _____ | X | _____ | _____ |
| e. Maintenance of public facilities, including roads? | _____ | X | _____ | _____ |
| f. Other governmental services?                       | _____ | X | _____ | _____ |

15. Energy. Will the proposal result in:

- |   |       |   |       |       |
|---|-------|---|-------|-------|
| a. Use of substantial amounts of fuel or energy?  | _____ | X | _____ | _____ |
| b. Substantial increase in demand upon existing sources of energy, or require the development of new sources of energy? | _____ | X | _____ | _____ |

16. Utilities. Except for planned improvements, will the proposal result in a need for new systems, or substantial alterations to the following utilities:

- |                              |       |   |       |       |
|------------------------------|-------|---|-------|-------|
| a. Power or natural gas?     | _____ | X | _____ | _____ |
| b. Communications systems?   | _____ | X | _____ | _____ |
| c. Water?                    | _____ | X | _____ | _____ |
| d. Sewer or septic tanks?    | _____ | X | _____ | _____ |
| e. Storm water drainage?     | _____ | Y | _____ | _____ |
| f. Solid waste and disposal? | _____ | Y | _____ | _____ |

17. Human Health. Will the proposal result in:

- |  |       |   |       |       |
|--|-------|---|-------|-------|
| a. Creation of any health hazard or potential health hazard (excluding mental health)? | _____ | Y | _____ | _____ |
| b. Exposure of people to potential health hazards?                                     | _____ | Y | _____ | _____ |

	<u>Yes</u>	<u>No</u>	<u>No, With Mitigation</u>	<u>Data Insufficient</u>
18. <u>Aesthetics.</u> Will the proposal result in the obstruction of any scenic vista or view open to the public, or will the proposal result in the creation of an aesthetically offensive site open to the public view?	_____	<u>X</u>	_____	_____
19. <u>Recreation.</u> Will the proposal result in an impact upon the quality or quantity of existing recreational opportunities?	_____	<u>X</u>	_____	_____
20. <u>Archeological/Historical.</u> Will the proposal result in an alteration of a significant archeological or historical site, structure, object or building?	_____	<u>X</u>	_____	_____
21. <u>Mandatory Findings of Significance.</u>				
a. Does the project have the potential to degrade the quality of the environment, substantially reduce the habitat of a fish population to drop below self-sustaining levels, threaten to eliminate a plant or animal community, reduce the number or restrict the range of a rare or endangered plant or animal or eliminate important examples of the major periods of California or Nevada history or prehistory?	_____	<u>X</u>	_____	_____
b. Does the project have the potential to achieve short-term, to the disadvantage of long-term, environmental goals? (A short-term impact on the environment is one which occurs in a relatively brief, definitive period of time, while long-term impacts will endure well into the future.)	_____	<u>X</u>	_____	_____
c. Does the project have impacts which are individually limited, but cumulatively considerable? (A project may impact on two or more separate resources where the impact on each resource is relatively small, but where the effect of the total of those impacts on the environment is significant.)	_____	<u>X</u>	_____	_____
d. Does the project have environmental effects which will cause substantial adverse effects on human being, either directly or indirectly?	_____	<u>X</u>	_____	_____

### III DISCUSSION OF ENVIRONMENTAL EVALUATION

All impacts identified with "yes" answers under Section II should be described below and evaluated as to their significance. All "no, with mitigation" responses require a description of the identified impact and the mitigation measure(s) proposed to mitigate the impact so that there is no significant impact.

#### 6. (a) NOISE LEVEL INCREASES

Intermittantly, throughout the entirety of the construction schedule, noise levels in the project area will be slightly elevated during the hours of 7:00 A.M. and 6:00 P.M. due to the use of a diesel powered backhoe which will be utilized to excavate gas distribution main trenches.

V CERTIFICATION

I hereby certify that the statements furnished above and in the attached exhibits present the data and information required for this initial evaluation to the best of my ability, and that the facts, statements, and information presented are true and correct to the best of my knowledge and belief.

✓ April 26, 1984  
(date)

R.L. Barbee- District Manager  
(name of person completing this form)

Robert L. Barbee  
(signature of person completing this form)  
13 9-18-85

DETERMINATION (to be completed by TRPA)

On the basis of this evaluation:

\_\_\_\_\_ The Agency finds the proposed activity to be categorically exempt under Section \_\_\_\_\_ of Ordinance 81-\_\_\_\_\_, prepared in accordance with Article VII(f) of the Tahoe Regional Planning Compact as amended.

\_\_\_\_\_ The Agency finds that the proposed project could not have a significant effect on the environment and a finding of no significant impact will be prepared.

\_\_\_\_\_ The Agency finds that the project could have a significant effect on the environment, but because of the listed mitigation measures which have been added to the project the project should have no significant effect on the environment and a conditional finding of no significant impact will be prepared.

\_\_\_\_\_ The Agency finds that the proposed project may have a significant effect on the environment and an environmental impact statement will be required.

\_\_\_\_\_  
DATE

\_\_\_\_\_  
SIGNATURE OF EVALUATOR

\_\_\_\_\_  
TITLE

TAHOE REGIONAL PLANNING AGENCY

ENVIRONMENTAL CHECK LIST FOR  
THE INITIAL DETERMINATION OF ENVIRONMENTAL IMPACT

PROJECT NAME OR IDENTIFICATION Extension of natural gas service to Tahoe Paradise.

ENVIRONMENTAL IMPACTS - The following questionnaire will be completed by the applicant based on evidence submitted with the application. All "yes" and "no, with mitigation" answers will require further written comments. See Section III of this questionnaire.

1. <u>Land</u> . Will the proposal result in:	<u>Yes</u>	<u>No</u>	<u>No, With Mitigation</u>	<u>Data Insufficient</u>
a. Compaction or covering of the soil beyond the limits prescribed in the land capability system?	_____	<u>X</u>	_____	_____
b. A change in the topography or ground surface relief features of site inconsistent with the natural surrounding conditions?	_____	<u>X</u>	_____	_____
c. Unstable earth conditions during or after completion of the proposal?	_____	<u>X</u>	_____	_____
d. Changes in the soil or geologic substructures?	_____	<u>X</u>	_____	_____
e. The continuation of or increase in wind or water erosion of soils, either on or off the site?	_____	<u>X</u>	_____	_____
f. Changes in deposition or erosion of beach sand, or changes in siltation, deposition or erosion which may modify the channel of a river or stream or the bed of a lake?	_____	<u>X</u>	_____	_____
g. Exposure of people or property to geologic hazards such as earthquakes, landslides, mudslides, ground failure, or similar hazards?	_____	<u>X</u>	_____	_____



	<u>Yes</u>	<u>No</u>	<u>No, With Mitigation</u>	<u>Data Insufficient</u>
2. <u>Air.</u> Will the proposal result in:				
a. Substantial air emissions or deterioration of ambient air quality?	_____	<u>X</u>	_____	_____
b. The creation of objectionable odors?	_____	<u>X</u>	_____	_____
c. Alteration of air movement, moisture or temperature, or any change in climate, either locally or regionally?	_____	<u>X</u>	_____	_____
3. <u>Water.</u> Will the proposal result in:				
a. Changes in currents, or the course or direction of water movements?	_____	<u>X</u>	_____	_____
b. Changes in absorption rates, drainage patterns, or the rate and amount of surface water runoff so that a 2 yr. 6 hr. storm runoff cannot be contained on the site?	_____	<u>X</u>	_____	_____
c. Alterations to the course or flow of 100 year flood waters?	_____	<u>X</u>	_____	_____
d. Change in the amount of surface water in any water body?	_____	<u>X</u>	_____	_____
e. Discharge into surface waters, or in any alteration of surface water quality, including but not limited to temperature, dissolved oxygen or turbidity?	_____	<u>X</u>	_____	_____
f. Alteration of the direction or rate of flow of ground waters?	_____	<u>X</u>	_____	_____
g. Change in the quantity of ground waters, either through direct additions or withdrawals, or through interception of an aquifer by cuts or excavations?	_____	<u>X</u>	_____	_____
h. Substantial reduction in the amount of water otherwise available for public water supplies?	_____	<u>X</u>	_____	_____
i. Exposure of people or property to water related hazards such as flooding and/or wave action from 100 year storm occurrence or seiches?	_____	<u>X</u>	_____	_____

	<u>Yes</u>	<u>No</u>	<u>No, With Mitigation</u>	<u>Data Insufficient</u>
<b>4. <u>Plant Life.</u> Will the proposal result in:</b>				
a. Removal of native vegetation in excess of the area utilized for the actual development permitted by the land capability system?	_____	X	_____	_____
b. Removal of riparian vegetation or other vegetation associated with critical wild-life habitat?	_____	X	_____	_____
c. Introduction of new vegetation that will require excessive fertilizer or water, or will provide a barrier to the normal replenishment of existing species.	_____	X	_____	_____
d. Change in the diversity of species, or number of any species of plants (including trees, shrubs, grass, crops, microflora and aquatic plants)?	_____	X	_____	_____
e. Reduction of the numbers of any unique, rare or endangered species of plants?	_____	X	_____	_____
<b>5. <u>Animal Life.</u> Will the proposal result in:</b>				
a. Change in the diversity of species, or numbers of any species of animals (birds, land animals including reptiles, fish and shellfish, benthic organisms, insects or microfauna)?	_____	X	_____	_____
b. Reduction of the number of any unique, rare or endangered species of animals?	_____	X	_____	_____
c. Introduction of new species of animals into an area, or result in a barrier to the migration or movement of animals?	_____	X	_____	_____
d. Deterioration to existing fish or wildlife habitat?	_____	X	_____	_____
<b>6. <u>Noise.</u> Will the proposal result in:</b>				
a. Increases in existing noise levels?	_____	_____	X	_____
b. Exposure of people to severe noise levels?	_____	X	_____	_____
<b>7. <u>Light and Glare.</u> Will the proposal produce new light or glare inconsistent with the surrounding area?</b>				
	_____	X	_____	_____
<b>8. <u>Land Use.</u> Will the proposal result in a substantial alteration of the present or planned land use of an area?</b>				
	_____	X	_____	_____

	<u>Yes</u>	<u>No</u>	<u>No, With Mitigation</u>	<u>Data Insufficient</u>
9. <u>Natural Resources.</u> Will the proposal result in:				
a. Increase in the rate of use of any natural resources?	_____	<u>X</u>	_____	_____
b. Substantial depletion of any non-renewable natural resource?	_____	<u>X</u>	_____	_____
10. <u>Risk of Upset.</u> Does the proposal involve a risk of an explosion or the release of hazardous substances (including, but not limited to, oil, pesticides, chemicals or radiation) in the event of an accident or upset conditions?	_____	<u>X</u>	_____	_____
11. <u>Population.</u> Will the proposal alter the location, distribution, density, or growth rate of the human population planned for the Region?	_____	<u>X</u>	_____	_____
12. <u>Housing.</u> Will the proposal affect existing housing, or create a demand for additional housing?	_____	<u>X</u>	_____	_____
13. <u>Transportation/Circulation.</u> Will the proposal result in:				
a. Generation of 100 or more vehicle trips or in excess of 1% of the remaining road capacity?	_____	<u>X</u>	_____	_____
b. Effects on existing parking facilities, or demand for new parking?	_____	<u>X</u>	_____	_____
c. Substantial impact upon existing transportation systems?	_____	<u>X</u>	_____	_____
d. Alterations to present patterns of circulation or movement of people and/or goods?	_____	<u>X</u>	_____	_____
e. Alterations to waterborne, rail or air traffic?	_____	<u>X</u>	_____	_____
f. Increase in traffic hazards to motor vehicles, bicyclists or pedestrians?	_____	<u>X</u>	_____	_____

<u>Yes</u>	<u>No</u>	<u>No, With Mitigation</u>	<u>Data Insufficient</u>
------------	-----------	----------------------------	--------------------------

14. Public Services. Will the proposal have an unplanned effect upon, or result in a need for new or altered governmental services in any of the following areas:

- |   |       |            |       |       |
|---|-------|------------|-------|-------|
| a. Fire protection?                                   | _____ | X<br>_____ | _____ | _____ |
| b. Police protection?                                 | _____ | X<br>_____ | _____ | _____ |
| c. Schools?   | _____ | X<br>_____ | _____ | _____ |
| d. Parks or other recreational facilities?            | _____ | X<br>_____ | _____ | _____ |
| e. Maintenance of public facilities, including roads? | _____ | X<br>_____ | _____ | _____ |
| f. Other governmental services?                       | _____ | X<br>_____ | _____ | _____ |

15. Energy. Will the proposal result in:

- |   |       |            |       |       |
|---|-------|------------|-------|-------|
| a. Use of substantial amounts of fuel or energy?  | _____ | X<br>_____ | _____ | _____ |
| b. Substantial increase in demand upon existing sources of energy, or require the development of new sources of energy? | _____ | X<br>_____ | _____ | _____ |

16. Utilities. Except for planned improvements, will the proposal result in a need for new systems, or substantial alterations to the following utilities:

- |                              |       |            |       |       |
|------------------------------|-------|------------|-------|-------|
| a. Power or natural gas?     | _____ | X<br>_____ | _____ | _____ |
| b. Communications systems?   | _____ | X<br>_____ | _____ | _____ |
| c. Water?                    | _____ | X<br>_____ | _____ | _____ |
| d. Sewer or septic tanks?    | _____ | X<br>_____ | _____ | _____ |
| e. Storm water drainage?     | _____ | X<br>_____ | _____ | _____ |
| f. Solid waste and disposal? | _____ | X<br>_____ | _____ | _____ |

17. Human Health. Will the proposal result in:

- |  |       |            |       |       |
|--|-------|------------|-------|-------|
| a. Creation of any health hazard or potential health hazard (excluding mental health)? | _____ | X<br>_____ | _____ | _____ |
| b. Exposure of people to potential health hazards?                                     | _____ | X<br>_____ | _____ | _____ |

	<u>Yes</u>	<u>No</u>	<u>No, With Mitigation</u>	<u>Data Insufficient</u>
18. <u>Aesthetics.</u> Will the proposal result in the obstruction of any scenic vista or view open to the public, or will the proposal result in the creation of an aesthetically offensive site open to the public view?	_____	X	_____	_____
19. <u>Recreation.</u> Will the proposal result in an impact upon the quality or quantity of existing recreational opportunities?	_____	X	_____	_____
20. <u>Archeological/Historical.</u> Will the proposal result in an alteration of a significant archeological or historical site, structure, object or building?	_____	X	_____	_____
21. <u>Mandatory Findings of Significance.</u>				
a. Does the project have the potential to degrade the quality of the environment, substantially reduce the habitat of a fish population to drop below self-sustaining levels, threaten to eliminate a plant or animal community, reduce the number or restrict the range of a rare or endangered plant or animal or eliminate important examples of the major periods of California or Nevada history or prehistory?	_____	X	_____	_____
b. Does the project have the potential to achieve short-term, to the disadvantage of long-term, environmental goals? (A short-term impact on the environment is one which occurs in a relatively brief, definitive period of time, while long-term impacts will endure well into the future.)	_____	X	_____	_____
c. Does the project have impacts which are individually limited, but cumulatively considerable? (A project may impact on two or more separate resources where the impact on each resource is relatively small, but where the effect of the total of those impacts on the environment is significant.)	_____	X	_____	_____
d. Does the project have environmental effects which will cause substantial adverse effects on human being, either directly or indirectly?	_____	X	_____	_____

## II DISCUSSION OF ENVIRONMENTAL EVALUATION

All impacts identified with "yes" answers under Section II should be described below and evaluated as to their significance. All "no, with mitigation" responses require a description of the identified impact and the mitigation measure(s) proposed to mitigate the impact so that there is no significant impact.

### 6. (a) NOISE LEVEL INCREASES

Intermittantly, throughout the entirety of the construction schedule, noise levels in the project area will be slightly elevated during the hours of 7:00 A.M. and 6:00 P.M. due to the use of a diesel powered backhoe which will be utilized to excavate gas distribution main trenches.

V CERTIFICATION

I hereby certify that the statements furnished above and in the attached exhibits present the data and information required for this initial evaluation to the best of my ability, and that the facts, statements, and information presented are true and correct to the best of my knowledge and belief.

✓ April 26 1984  
(date)

R. I. Barbee - District Manager  
(name of person completing this form)

R. I. Barbee  
(signature of person completing this form)

3 9-11-85

7 DETERMINATION (to be completed by TRPA)

On the basis of this evaluation:

\_\_\_\_\_ The Agency finds the proposed activity to be categorically exempt under Section \_\_\_\_\_ of Ordinance 81-\_\_\_\_\_, prepared in accordance with Article VII(f) of the Tahoe Regional Planning Compact as amended.

\_\_\_\_\_ The Agency finds that the proposed project could not have a significant effect on the environment and a finding of no significant impact will be prepared.

\_\_\_\_\_ The Agency finds that the project could have a significant effect on the environment, but because of the listed mitigation measures which have been added to the project the project should have no significant effect on the environment and a conditional finding of no significant impact will be prepared.

\_\_\_\_\_ The Agency finds that the proposed project may have a significant effect on the environment and an environmental impact statement will be required.

\_\_\_\_\_  
DATE

\_\_\_\_\_  
SIGNATURE OF EVALUATOR

\_\_\_\_\_  
TITLE

TAHOE REGIONAL PLANNING AGENCY

ENVIRONMENTAL CHECK LIST FOR  
THE INITIAL DETERMINATION OF ENVIRONMENTAL IMPACT

PROJECT NAME OR IDENTIFICATION Extension of natural gas service to

Tahoe Broder Estates #1

ENVIRONMENTAL IMPACTS - The following questionnaire will be completed by the applicant based on evidence submitted with the application. All "yes" and "no, with mitigation" answers will require further written comments. See Section III of this questionnaire.

	<u>Yes</u>	<u>No</u>	<u>No, With Mitigation</u>	<u>Data Insufficient</u>
1. <u>Land</u> . Will the proposal result in:				
a. Compaction or covering of the soil beyond the limits prescribed in the land capability system?	_____	<u>X</u>	_____	_____
b. A change in the topography or ground surface relief features of site inconsistent with the natural surrounding conditions?	_____	<u>X</u>	_____	_____
c. Unstable earth conditions during or after completion of the proposal?	_____	<u>X</u>	_____	_____
d. Changes in the soil or geologic substructures?	_____	<u>X</u>	_____	_____
e. The continuation of or increase in wind or water erosion of soils, either on or off the site?	_____	<u>X</u>	_____	_____
f. Changes in deposition or erosion of beach sand, or changes in siltation, deposition or erosion which may modify the channel of a river or stream or the bed of a lake?	_____	<u>X</u>	_____	_____
g. Exposure of people or property to geologic hazards such as earthquakes, landslides, mudslides, ground failure, or similar hazards?	_____	<u>X</u>	_____	_____



	<u>Yes</u>	<u>No</u>	<u>No, With Mitigation</u>	<u>Data Insufficient</u>
2. <u>Air.</u> Will the proposal result in:				
a. Substantial air emissions or deterioration of ambient air quality?	_____	<u>X</u>	_____	_____
b. The creation of objectionable odors?	_____	<u>X</u>	_____	_____
c. Alteration of air movement, moisture or temperature, or any change in climate, either locally or regionally?	_____	<u>X</u>	_____	_____
3. <u>Water.</u> Will the proposal result in:				
a. Changes in currents, or the course or direction of water movements?	_____	<u>X</u>	_____	_____
b. Changes in absorption rates, drainage patterns, or the rate and amount of surface water runoff so that a 2 yr. 6 hr. storm runoff cannot be contained on the site?	_____	<u>X</u>	_____	_____
c. Alterations to the course or flow of 100 year flood waters?	_____	<u>X</u>	_____	_____
d. Change in the amount of surface water in any water body?	_____	<u>X</u>	_____	_____
e. Discharge into surface waters, or in any alteration of surface water quality, including but not limited to temperature, dissolved oxygen or turbidity?	_____	<u>X</u>	_____	_____
f. Alteration of the direction or rate of flow of ground waters?	_____	<u>X</u>	_____	_____
g. Change in the quantity of ground waters, either through direct additions or withdrawals, or through interception of an aquifer by cuts or excavations?	_____	<u>X</u>	_____	_____
h. Substantial reduction in the amount of water otherwise available for public water supplies?	_____	<u>X</u>	_____	_____
i. Exposure of people or property to water related hazards such as flooding and/or wave action from 100 year storm occurrence or seiches?	_____	<u>X</u>	_____	_____

	<u>Yes</u>	<u>No</u>	<u>No, With Mitigation</u>	<u>Data Insufficient</u>
4. <u>Plant Life.</u> Will the proposal result in:				
a. Removal of native vegetation in excess of the area utilized for the actual development permitted by the land capability system?	_____	X	_____	_____
b. Removal of riparian vegetation or other vegetation associated with critical wild-life habitat?	_____	X	_____	_____
c. Introduction of new vegetation that will require excessive fertilizer or water, or will provide a barrier to the normal replenishment of existing species.	_____	X	_____	_____
d. Change in the diversity of species, or number of any species of plants (including trees, shrubs, grass, crops, microflora and aquatic plants)?	_____	X	_____	_____
e. Reduction of the numbers of any unique, rare or endangered species of plants?	_____	X	_____	_____
5. <u>Animal Life.</u> Will the proposal result in:				
a. Change in the diversity of species, or numbers of any species of animals (birds, land animals including reptiles, fish and shellfish, benthic organisms, insects or microfauna)?	_____	X	_____	_____
b. Reduction of the number of any unique, rare or endangered species of animals?	_____	X	_____	_____
c. Introduction of new species of animals into an area, or result in a barrier to the migration or movement of animals?	_____	X	_____	_____
d. Deterioration to existing fish or wildlife habitat?	_____	X	_____	_____
6. <u>Noise.</u> Will the proposal result in:				
a. Increases in existing noise levels?	_____	_____	X	_____
b. Exposure of people to severe noise levels?	_____	X	_____	_____
7. <u>Light and Glare.</u> Will the proposal produce new light or glare inconsistent with the surrounding area?	_____	X	_____	_____
8. <u>Land Use.</u> Will the proposal result in a substantial alteration of the present or planned land use of an area?	_____	X	_____	_____

<u>Yes</u>	<u>No</u>	<u>No, With Mitigation</u>	<u>Data Insufficient</u>
------------	-----------	----------------------------	--------------------------

9. Natural Resources. Will the proposal result in:

a. Increase in the rate of use of any natural resources?

\_\_\_\_\_ Y \_\_\_\_\_ \_\_\_\_\_

b. Substantial depletion of any non-renewable natural resource?

\_\_\_\_\_ X \_\_\_\_\_ \_\_\_\_\_

10. Risk of Upset. Does the proposal involve a risk of an explosion or the release of hazardous substances (including, but not limited to, oil, pesticides, chemicals or radiation) in the event of an accident or upset conditions?

\_\_\_\_\_ X \_\_\_\_\_ \_\_\_\_\_

11. Population. Will the proposal alter the location, distribution, density, or growth rate of the human population planned for the Region?

\_\_\_\_\_ X \_\_\_\_\_ \_\_\_\_\_

12. Housing. Will the proposal affect existing housing, or create a demand for additional housing?

\_\_\_\_\_ X \_\_\_\_\_ \_\_\_\_\_

13. Transportation/Circulation. Will the proposal result in:

a. Generation of 100 or more vehicle trips or in excess of 1% of the remaining road capacity?

\_\_\_\_\_ X \_\_\_\_\_ \_\_\_\_\_

b. Effects on existing parking facilities, or demand for new parking?

\_\_\_\_\_ X \_\_\_\_\_ \_\_\_\_\_

c. Substantial impact upon existing transportation systems?

\_\_\_\_\_ X \_\_\_\_\_ \_\_\_\_\_

d. Alterations to present patterns of circulation or movement of people and/or goods?

\_\_\_\_\_ X \_\_\_\_\_ \_\_\_\_\_

e. Alterations to waterborne, rail or air traffic?

\_\_\_\_\_ X \_\_\_\_\_ \_\_\_\_\_

f. Increase in traffic hazards to motor vehicles, bicyclists or pedestrians?

\_\_\_\_\_ X \_\_\_\_\_ \_\_\_\_\_

Yes      No      No, With Mitigation      Data Insufficient

14. Public Services. Will the proposal have an unplanned effect upon, or result in a need for new or altered governmental services in any of the following areas:

- a. Fire protection? \_\_\_\_\_ X \_\_\_\_\_
- b. Police protection? \_\_\_\_\_ X \_\_\_\_\_
- c. Schools? \_\_\_\_\_ X \_\_\_\_\_
- d. Parks or other recreational facilities? \_\_\_\_\_ X \_\_\_\_\_
- e. Maintenance of public facilities, including roads? \_\_\_\_\_ X \_\_\_\_\_
- f. Other governmental services? \_\_\_\_\_ X \_\_\_\_\_

15. Energy. Will the proposal result in:

- a. Use of substantial amounts of fuel or energy? \_\_\_\_\_ X \_\_\_\_\_
- b. Substantial increase in demand upon existing sources of energy, or require the development of new sources of energy? \_\_\_\_\_ X \_\_\_\_\_

16. Utilities. Except for planned improvements, will the proposal result in a need for new systems, or substantial alterations to the following utilities:

- a. Power or natural gas? \_\_\_\_\_ X \_\_\_\_\_
- b. Communications systems? \_\_\_\_\_ X \_\_\_\_\_
- c. Water? \_\_\_\_\_ X \_\_\_\_\_
- d. Sewer or septic tanks? \_\_\_\_\_ X \_\_\_\_\_
- e. Storm water drainage? \_\_\_\_\_ X \_\_\_\_\_
- f. Solid waste and disposal? \_\_\_\_\_ X \_\_\_\_\_

17. Human Health. Will the proposal result in:

- a. Creation of any health hazard or potential health hazard (excluding mental health)? \_\_\_\_\_ X \_\_\_\_\_
- b. Exposure of people to potential health hazards? \_\_\_\_\_ X \_\_\_\_\_

	<u>Yes</u>	<u>No</u>	<u>No, With Mitigation</u>	<u>Data Insufficient</u>
18. <u>Aesthetics</u> . Will the proposal result in the obstruction of any scenic vista or view open to the public, or will the proposal result in the creation of an aesthetically offensive site open to the public view?	_____	<u>X</u>	_____	_____
19. <u>Recreation</u> . Will the proposal result in an impact upon the quality or quantity of existing recreational opportunities?	_____	<u>X</u>	_____	_____
20. <u>Archeological/Historical</u> . Will the proposal result in an alteration of a significant archeological or historical site, structure, object or building?	_____	<u>X</u>	_____	_____
21. <u>Mandatory Findings of Significance</u> .				
a. Does the project have the potential to degrade the quality of the environment, substantially reduce the habitat of a fish population to drop below self-sustaining levels, threaten to eliminate a plant or animal community, reduce the number or restrict the range of a rare or endangered plant or animal or eliminate important examples of the major periods of California or Nevada history or prehistory?	_____	<u>X</u>	_____	_____
b. Does the project have the potential to achieve short-term, to the disadvantage of long-term, environmental goals? (A short-term impact on the environment is one which occurs in a relatively brief, definitive period of time, while long-term impacts will endure well into the future.)	_____	<u>X</u>	_____	_____
c. Does the project have impacts which are individually limited, but cumulatively considerable? (A project may impact on two or more separate resources where the impact on each resource is relatively small, but where the effect of the total of those impacts on the environment is significant.)	_____	<u>X</u>	_____	_____
d. Does the project have environmental effects which will cause substantial adverse effects on human being, either directly or indirectly?	_____	<u>X</u>	_____	_____

## II DISCUSSION OF ENVIRONMENTAL EVALUATION

All impacts identified with "yes" answers under Section II should be described below and evaluated as to their significance. All "no, with mitigation" responses require a description of the identified impact and the mitigation measure(s) proposed to mitigate the impact so that there is no significant impact.

### 6.(a) NOISE LEVEL INCREASES

Intermittantly, throughout the entirety of the construction schedule, noise levels in the project area will be slightly elevated during the hours of 7:00 A.M. and 6:00 P.M. due to the use of a diesel powered backhoe which will be utilized to excavate gas distribution main trenches.

V CERTIFICATION

I hereby certify that the statements furnished above and in the attached exhibits present the data and information required for this initial evaluation to the best of my ability, and that the facts, statements, and information presented are true and correct to the best of my knowledge and belief.

✓ April 26 1984  
(date)

R.L. Barbee- District Manager  
(name of person completing this form)

Robert L Barbee  
(signature of person completing this form)

179-18-85

7 DETERMINATION (to be completed by TRPA)

On the basis of this evaluation:

\_\_\_\_\_ The Agency finds the proposed activity to be categorically exempt under Section \_\_\_\_\_ of Ordinance 81-\_\_\_\_\_, prepared in accordance with Article VII(f) of the Tahoe Regional Planning Compact as amended.

\_\_\_\_\_ The Agency finds that the proposed project could not have a significant effect on the environment and a finding of no significant impact will be prepared.

\_\_\_\_\_ The Agency finds that the project could have a significant effect on the environment, but because of the listed mitigation measures which have been added to the project the project should have no significant effect on the environment and a conditional finding of no significant impact will be prepared.

\_\_\_\_\_ The Agency finds that the proposed project may have a significant effect on the environment and an environmental impact statement will be required.

\_\_\_\_\_  
DATE

\_\_\_\_\_  
SIGNATURE OF EVALUATOR

\_\_\_\_\_  
TITLE

TAHOE REGIONAL PLANNING AGENCY

ENVIRONMENTAL CHECK LIST FOR  
THE INITIAL DETERMINATION OF ENVIRONMENTAL IMPACT

PROJECT NAME OR IDENTIFICATION Extension of natural gas service to  
Country Club Estates #1 & #2

ENVIRONMENTAL IMPACTS - The following questionnaire will be completed by the applicant based on evidence submitted with the application. All "yes" and "no, with mitigation" answers will require further written comments. See Section III of this questionnaire.

	<u>Yes</u>	<u>No</u>	<u>No, With Mitigation</u>	<u>Data Insufficient</u>
1. <u>Land</u> . Will the proposal result in:				
a. Compaction or covering of the soil beyond the limits prescribed in the land capability system?	_____	<u>Y</u>	_____	_____
b. A change in the topography or ground surface relief features of site inconsistent with the natural surrounding conditions?	_____	<u>Y</u>	_____	_____
c. Unstable earth conditions during or after completion of the proposal?	_____	<u>Y</u>	_____	_____
d. Changes in the soil or geologic substructures?	_____	<u>Y</u>	_____	_____
e. The continuation of or increase in wind or water erosion of soils, either on or off the site?	_____	<u>Y</u>	_____	_____
f. Changes in deposition or erosion of beach sand, or changes in siltation, deposition or erosion which may modify the channel of a river or stream or the bed of a lake?	_____	<u>Y</u>	_____	_____
g. Exposure of people or property to geologic hazards such as earthquakes, landslides, mudslides, ground failure, or similar hazards?	_____	<u>Y</u>	_____	_____



	<u>Yes</u>	<u>No</u>	<u>No, With Mitigation</u>	<u>Data Insufficient</u>
2. <u>Air.</u> Will the proposal result in:				
a. Substantial air emissions or deterioration of ambient air quality?	_____	<u>X</u>	_____	_____
b. The creation of objectionable odors?	_____	<u>X</u>	_____	_____
c. Alteration of air movement, moisture or temperature, or any change in climate, either locally or regionally?	_____	<u>X</u>	_____	_____
3. <u>Water.</u> Will the proposal result in:				
a. Changes in currents, or the course or direction of water movements?	_____	<u>X</u>	_____	_____
b. Changes in absorption rates, drainage patterns, or the rate and amount of surface water runoff so that a 2 yr. 6 hr. storm runoff cannot be contained on the site?	_____	<u>X</u>	_____	_____
c. Alterations to the course or flow of 100 year flood waters?	_____	<u>X</u>	_____	_____
d. Change in the amount of surface water in any water body?	_____	<u>X</u>	_____	_____
e. Discharge into surface waters, or in any alteration of surface water quality, including but not limited to temperature, dissolved oxygen or turbidity?	_____	<u>X</u>	_____	_____
f. Alteration of the direction or rate of flow of ground waters?	_____	<u>X</u>	_____	_____
g. Change in the quantity of ground waters, either through direct additions or withdrawals, or through interception of an aquifer by cuts or excavations?	_____	<u>X</u>	_____	_____
h. Substantial reduction in the amount of water otherwise available for public water supplies?	_____	<u>X</u>	_____	_____
i. Exposure of people or property to water related hazards such as flooding and/or wave action from 100 year storm occurrence or seiches?	_____	<u>X</u>	_____	_____

	<u>Yes</u>	<u>No</u>	<u>No, With Mitigation</u>	<u>Data Insufficient</u>
4. <u>Plant Life.</u> Will the proposal result in:				
a. Removal of native vegetation in excess of the area utilized for the actual development permitted by the land capability system?	_____	<u>X</u>	_____	_____
b. Removal of riparian vegetation or other vegetation associated with critical wild-life habitat?	_____	<u>X</u>	_____	_____
c. Introduction of new vegetation that will require excessive fertilizer or water, or will provide a barrier to the normal replenishment of existing species.	_____	<u>X</u>	_____	_____
d. Change in the diversity of species, or number of any species of plants (including trees, shrubs, grass, crops, microflora and aquatic plants)?	_____	<u>X</u>	_____	_____
e. Reduction of the numbers of any unique, rare or endangered species of plants?	_____	<u>X</u>	_____	_____
5. <u>Animal Life.</u> Will the proposal result in:				
a. Change in the diversity of species, or numbers of any species of animals (birds, land animals including reptiles, fish and shellfish, benthic organisms, insects or microfauna)?	_____	<u>X</u>	_____	_____
b. Reduction of the number of any unique, rare or endangered species of animals?	_____	<u>X</u>	_____	_____
c. Introduction of new species of animals into an area, or result in a barrier to the migration or movement of animals?	_____	<u>X</u>	_____	_____
d. Deterioration to existing fish or wildlife habitat?	_____	<u>X</u>	_____	_____
6. <u>Noise.</u> Will the proposal result in:				
a. Increases in existing noise levels?	_____	_____	<u>X</u>	_____
b. Exposure of people to severe noise levels?	_____	<u>X</u>	_____	_____
7. <u>Light and Glare.</u> Will the proposal produce new light or glare inconsistent with the surrounding area?				
	_____	<u>X</u>	_____	_____
8. <u>Land Use.</u> Will the proposal result in a substantial alteration of the present or planned land use of an area?				
	_____	<u>X</u>	_____	_____