



- Cruise Green

- Charter Information

- Educational Bay Cruises

- Press Info and Media

- Environmental Features

- Visiting Alcatraz

- Book a Hornblower Cruise

Energy and Fuel Savings



- We built the Hornblower Hybrid by reusing another boat. In doing so, we saved more than 735,000 KWh of electricity in the construction and retrofit of the vessel. That is the equivalent of taking more than 60 U.S. homes off the grid for an entire year!
- Instead of idling at the dock or burning diesel to keep the lights on (a standard practice in the industry) the Hornblower Hybrid switches from diesel power to battery mode to save fuel and reduce emissions.
- The Hornblower Hybrid will reduce our annual diesel consumption by more than 29,000 gallons! That is equivalent to taking 58 cars off the road permanently or planting 90 acres of trees.
- The hybrid boat uses approximately six gallons of diesel fuel per hour, compared to 30 gallons per hour used by a conventional ferryboat.



Green Interior

- Carpet - contains Everset Fibers made from post-consumer recycled materials and is also recyclable.
- Countertops – indoor and outdoor bars are made from pieces of recycled glass by Vetrazzo, Inc.
- Lights - the boat is fully equipped with an LED lighting system. All LED lights onboard are equivalent to one 100-Watt incandescent light bulb.
- Interior signage - printed on Plyboo, a sustainably-sourced composite containing no harmful chemicals or materials.
- All interior modifications meet the United States Green Building Council's LEED criteria for recycled content.

For more information on how to take a ride on the Hornblower Hybrid, please call (415)438-8320 or email getinvolved@respectourplanet.com

• Diagrams and Amenities



• Videos

- How It Works

UPPER DECK

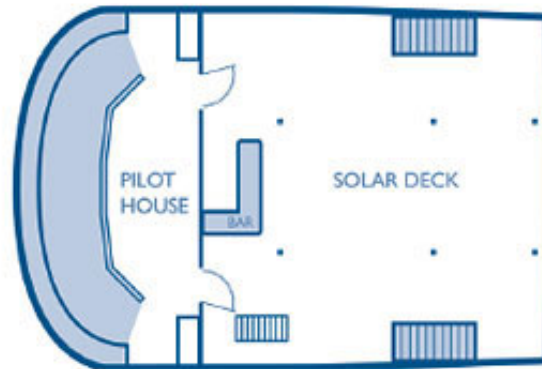

MAIN DECK

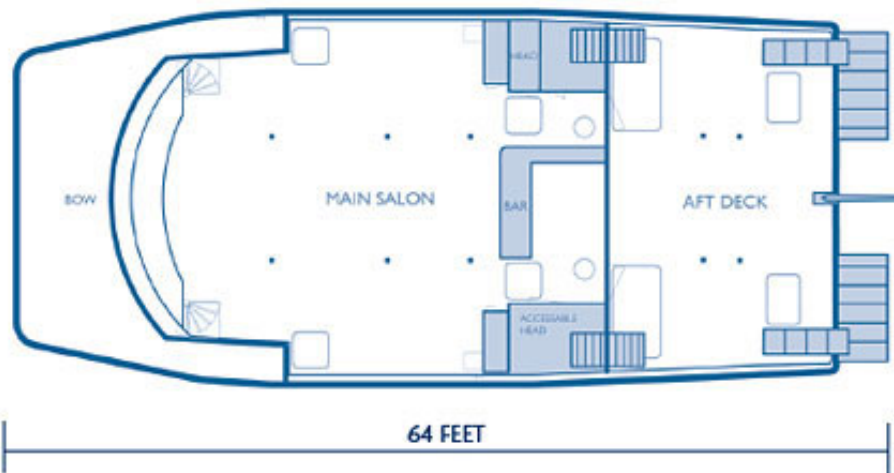

THE BOAT

- Length: 64 feet
- Maximum USCG capacity: 149
- Maximum cocktail capacity: 110
- Sound system has iPod and CD capabilities
- Flat screens are DVD or laptop-ready
- Cordless microphone included

BOW

- Open-air deck with comfortable seating
- Excellent water-level viewing

MAIN SALON

- Full bar
- Passive heating from electric inverter drives (uses no additional energy)
- Restroom

AFT DECK

- Outer deck functions as a foyer

SOLAR DECK

- Upper-level aft outer deck
- Partial coverage by permanent canopy
- Built-in outdoor bar
- Exceptional, panoramic views

PILOT HOUSE

- Accommodates 2 cocktail tables
- Interactive energy displays
- 2 flat-screen LCD televisions
- Port and starboard display countertops

